



A.caminetti

ABOUT US



For more than 27 years Acaminetti company from a small Italian family business has developed into a large company that meets all the requirements of customers.

Acaminetti adheres to all standards, simplicity in reliability and refinement in design.

A.caminetti has been committed to generating heat conveniently, economically, with environmental responsibility and in accordance with demand. With a wide variety of outstanding product developments and problem-solving solutions, A.Caminetti has created milestones that have often made them the trailblazer and trendsetter for their entire industry. A.Caminetti orientation is decisively international - as it exports in Europe,Asia,Africa

-The quality of the materials made, the ease of operation and reasonable prices will not leave indifferent even the most demanding buyer.

-Glass in A. Caminetti stone furnaces are presented in such types:

- Prismatic glass

- Flat glass

- Corner glass

- 3 side glass (3D)

- 4 side glass (4D)

A. Caminetti fireplace inserts have the following characteristics:

- Each model can be order under individual SIZE

- The fireplaces are made of steel, which provides you with reliable use for decades

- Guarantee in 5 years will allow you to be calm and confident in the reliability of the company

- Fuel for briquettes and firewood

- High power will provide heating even a large room

- ISO 9001:2008 standards guarantee you quality

A.caminetti glass model

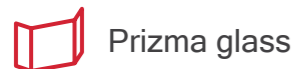

Prizma glass

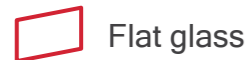

Flat glass

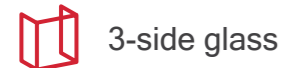



3-side glass



4-side glass

A.caminetti fireplace have the following characteristic

 The fireplaces are made of steel, which provides you with reliable use for decades

 The 5 year warranty will allow you to be calm and confident in the reliability of the company

 Fuel on briquettes and wood

 High power will ensure the heating of even a large room

 The standards of ISO 9001: 2008 provide a quality guarantee



MODELS:

FLAT



PRIZMA



A.caminetti

CRYSTAL

WOOD BURNING FIREPLACES



QUATTRO





FLAT 75 X 50

A.camineti

SERIA Flat

TECHNICAL SPECIFICATION

| | |
|---------------------------|-----------------|
| Model | FLAT 75x50 |
| Power (max) | 10-13 kw |
| Outlet temperature/smoke | 230°C |
| Efficiency | 80% |
| Consume | 2-3 Kg/h |
| Fireplace material | Ceramic / Steel |
| Fan air supply | 100 x 230 mm |
| Hot air outlet | 4 x Ø100 mm |
| Weight | 270 kg |
| Air temperature at outlet | 120°C |
| Fuel | Wood/Briquette |
| Pipe diameter | Ø 200 mm |
| Glass | Ceramic |
| Warranty | 5 years |

OVERALL DIMENSION

| | |
|--------|---------|
| Height | 1550 mm |
| Depth | 600 mm |
| Width | 1083 mm |

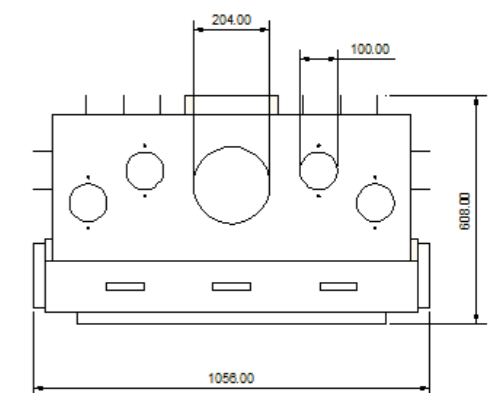
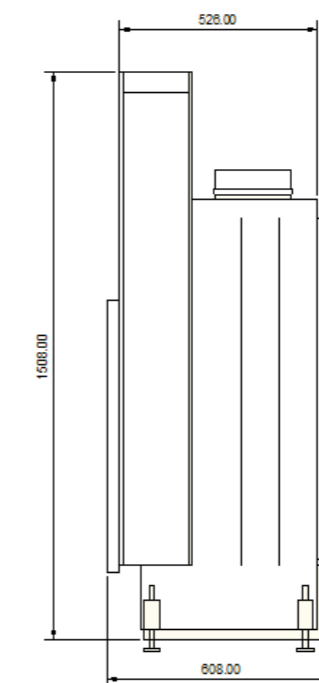
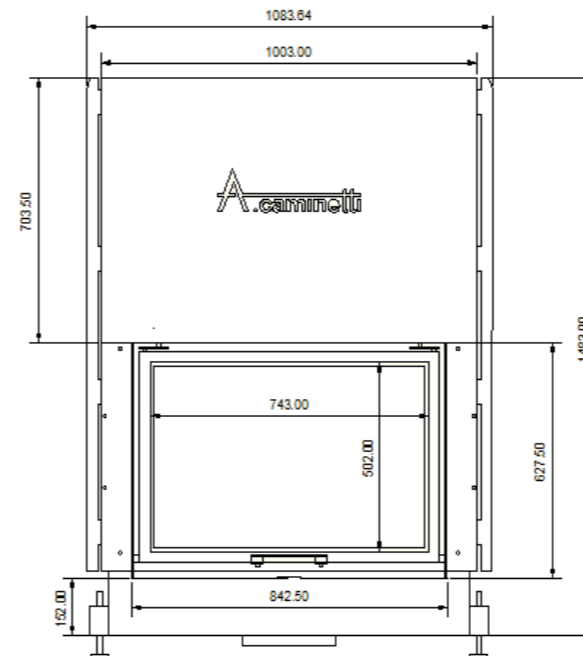

FLAT 75 X 60

A.camineti

SERIA Flat

TECHNICAL SPECIFICATION

| | |
|---------------------------|-----------------|
| Model | FLAT 75x60 |
| Power (max) | 10-13 kw |
| Outlet temperature/smoke | 230°C |
| Efficiency | 80% |
| Consume | 3-4 Kg/h |
| Fireplace material | Ceramic / Steel |
| Fan air supply | 100 x 230 mm |
| Hot air outlet | 4 x ø100 mm |
| Weight | 290 kg |
| Air temperature at outlet | 120°C |
| Fuel | Wood/Briquette |
| Pipe diameter | ø 200 mm |
| Glass | Ceramic |
| Warranty | 5 years |

OVERALL DIMENSION

| | |
|--------|---------|
| Height | 1550 mm |
| Depth | 600 mm |
| Width | 1083 mm |

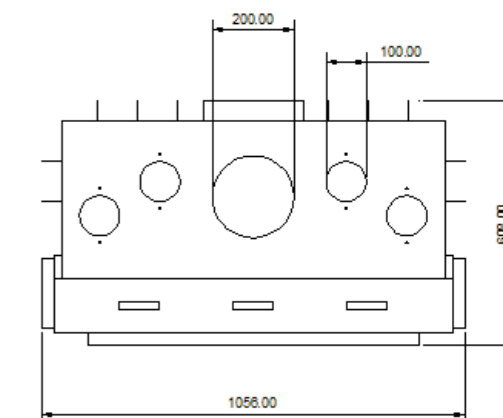
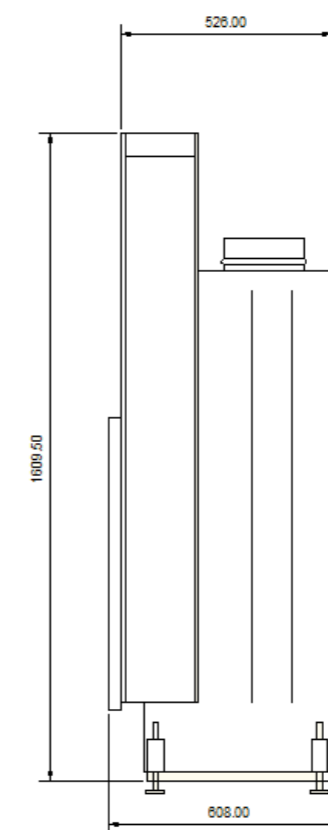
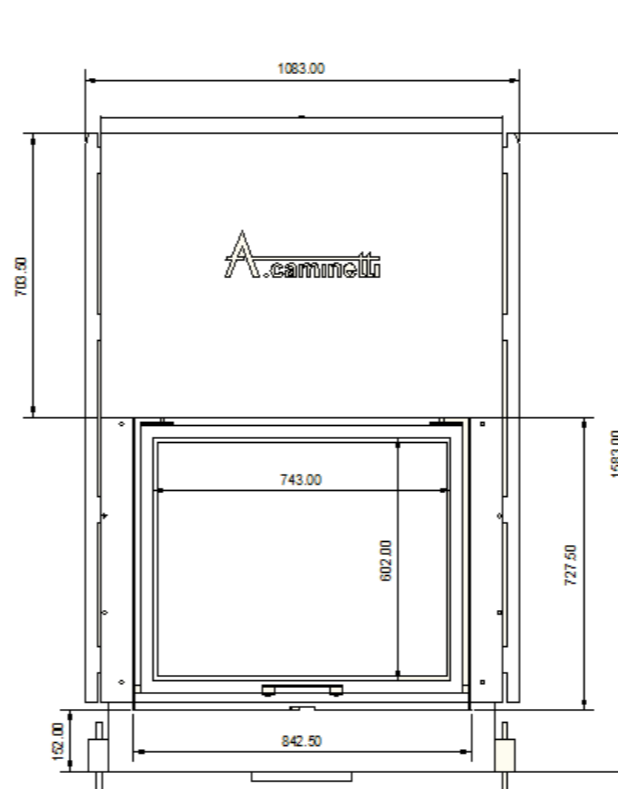

FLAT 90 X 50

A.camineti

SERIA Flat

TECHNICAL SPECIFICATION

| | |
|---------------------------|-----------------|
| Model | FLAT 90X50 |
| Power (max) | 10 -14 kw |
| Outlet temperature/smoke | 240°□ |
| Efficiency | 80% |
| Consume | 3-4 Kg/h |
| Fireplace material | Ceramic / Steel |
| Fan air supply | 100 x 230 mm |
| Hot air outlet | 4 x fi 100 mm |
| Weight | 320 kg |
| Air temperature at outlet | 120°C |
| Fuel | Wood/Briquette |
| Pipe diameter | ø 200 mm |
| Glass | Ceramic |
| Warranty | 5 years |

OVERALL DIMENSION

| | |
|--------|---------|
| Height | 1550 mm |
| Depth | 600 mm |
| Width | 1233 mm |

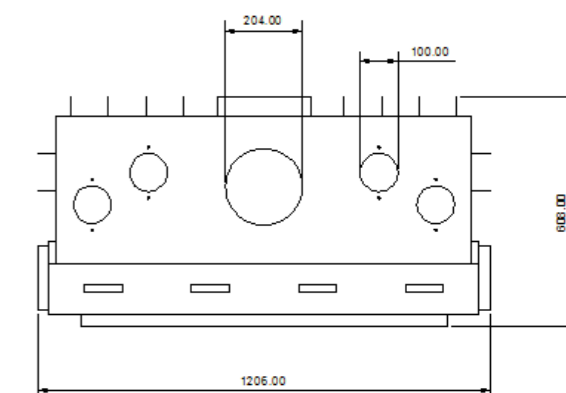
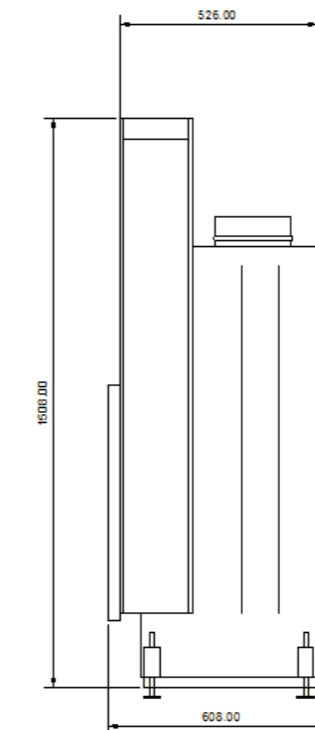
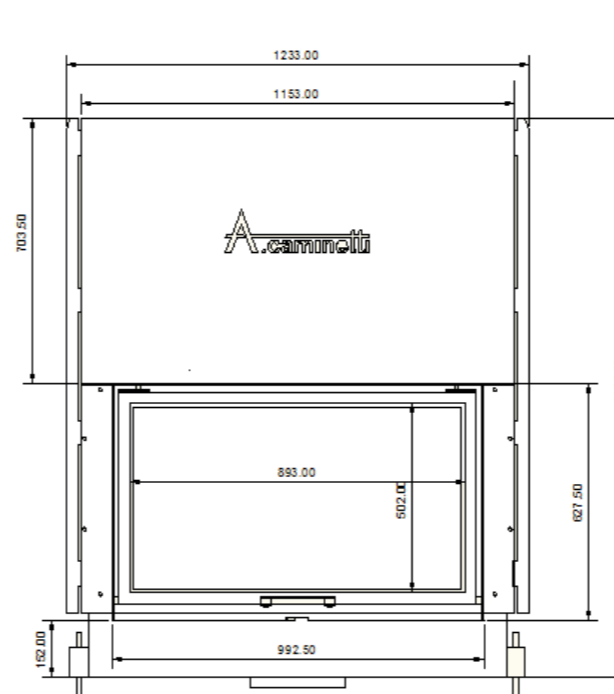

FLAT 90 X 60

A.camineti

SERIA Flat

TECHNICAL SPECIFICATION

| | |
|---------------------------|-----------------|
| Model | FLAT 90 X 60 |
| Powe (max) | 10-14 kw |
| Outlet temperature/smoke | 230°C |
| Efficiency | 80% |
| Consume | 3-4 kg/h |
| Fireplace material | Ceramic / Steel |
| Fan air supply | 100 x 230 mm |
| Hot air outlet | 4 x ø100 mm |
| Weight | 354 kg |
| Air temperature at outlet | 120°C |
| Fuel | Wood/Briquette |
| Pipe diameter | ø 200 mm |
| Glass | Ceramic |
| Warranty | 5 years |

OVERALL DIMENSION

| | |
|--------|---------|
| Height | 1550 mm |
| Depth | 600 mm |
| Width | 1233 mm |

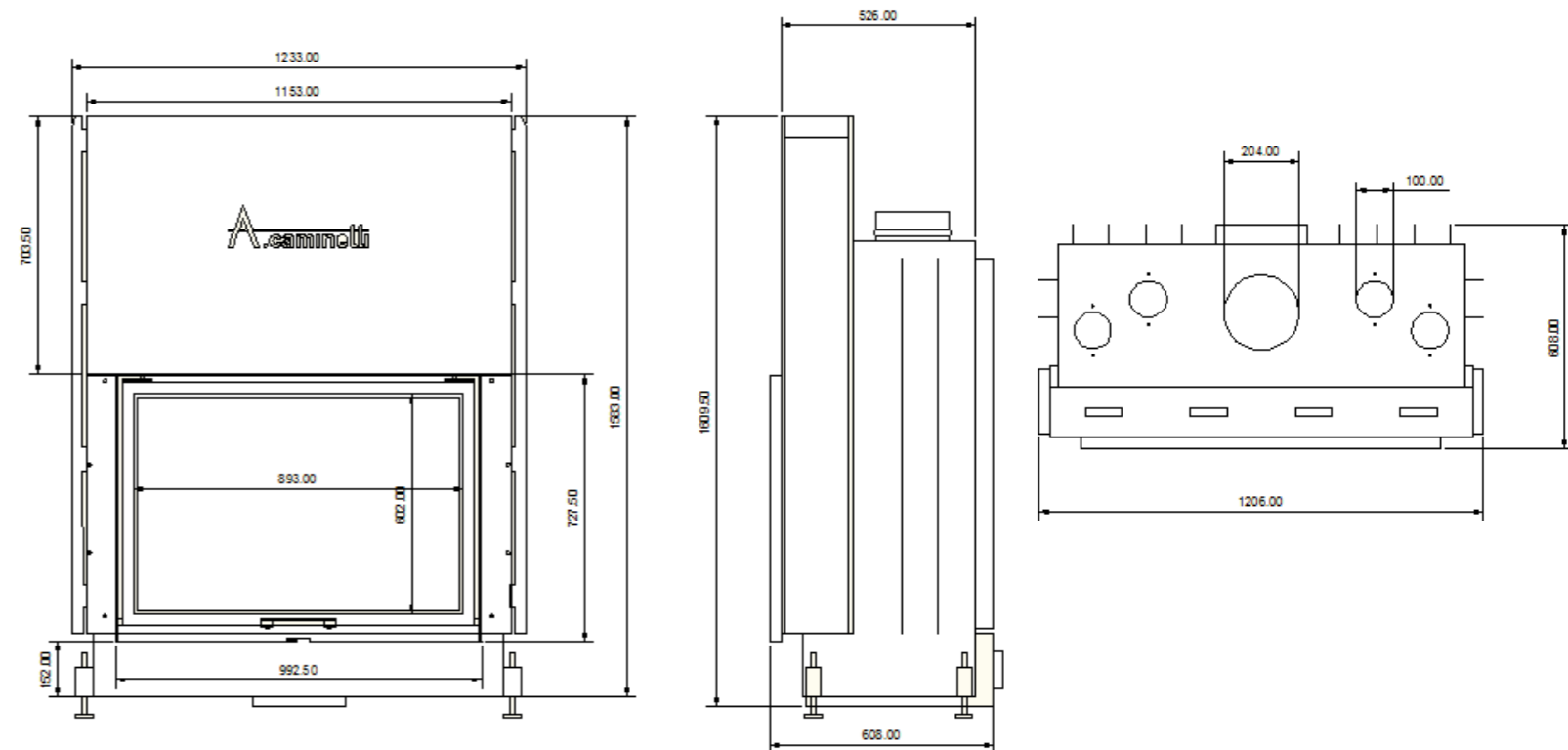

FLAT 90 X 70

A.camineti

SERIA Flat

TECHNICAL SPECIFICATION

| | |
|---------------------------|-----------------|
| Model | FLAT 90 X 70 |
| Powe (max) | 11-15 kw |
| Outlet temperature/smoke | 240°C |
| Efficiency | 80% |
| Consume | 3-4 kg/h |
| Fireplace material | Ceramic / Steel |
| Fan air supply | 100 x 230 mm |
| Hot air outlet | 4 x ø100 mm |
| Weight | 374 kg |
| Air temperature at outlet | 120°C |
| Fuel | Wood/Briquette |
| Pipe diameter | ø 200 mm |
| Glass | Ceramic |
| Warranty | 5 years |

OVERALL DIMENSION

| | |
|--------|---------|
| Height | 1650 mm |
| Depth | 600 mm |
| Width | 1233 mm |

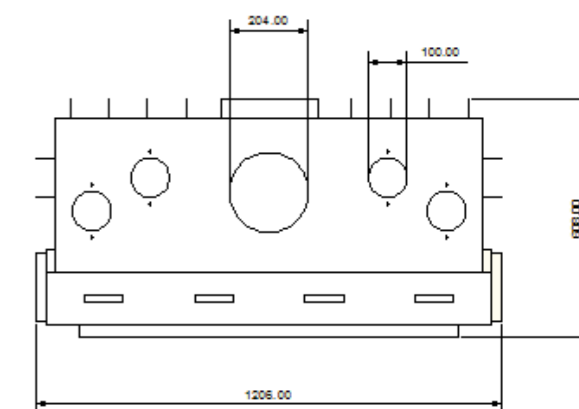
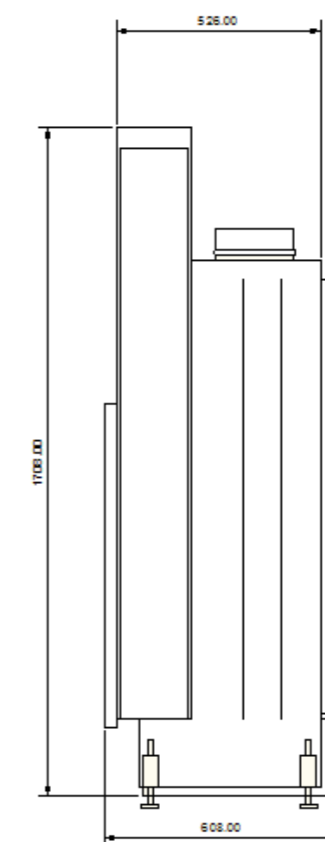
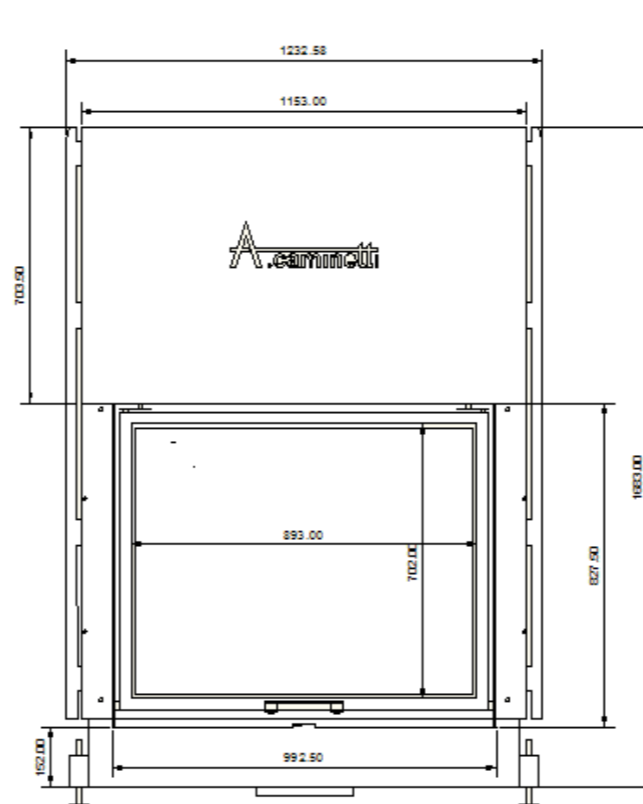

FLAT 120X50

A.caminetti

SERIA Flat

TECHNICAL SPECIFICATION

| | |
|---------------------------|-----------------|
| Model | FLAT 120X50 |
| Powe (max) | 18 kw |
| Outlet temperature/smoke | 240°C |
| Efficiency | 80% |
| Consume | 3-4 kg/h |
| Fireplace material | Ceramic / Steel |
| Fan air supply | 100 x 230 mm |
| Hot air outlet | 4 x ø100 mm |
| Weight | 400 kg |
| Air temperature at outlet | 120°C |
| Fuel | Wood/Briquette |
| Pipe diameter | ø 250 mm |
| Glass | Ceramic |
| Warranty | 5 years |

OVERALL DIMENSION

| | |
|--------|---------|
| Height | 1500 mm |
| Depth | 600 mm |
| Width | 1453 mm |

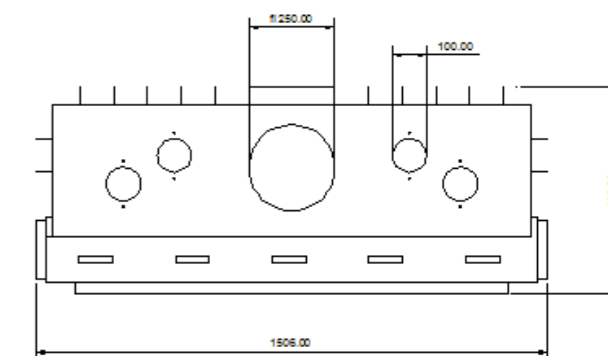
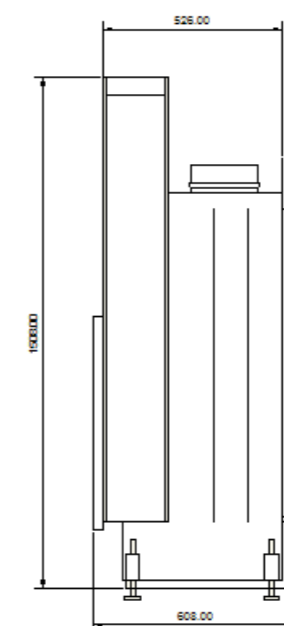
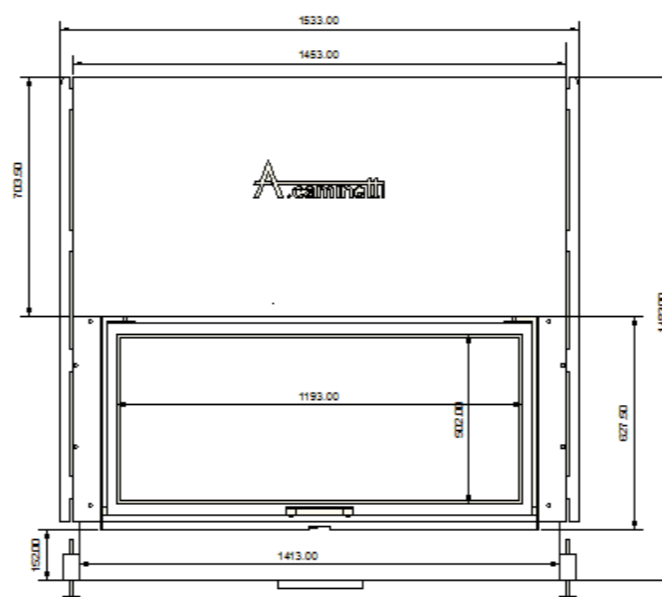

FLAT 150 X 50

A.caminetti

SERIA Flat

TECHNICAL SPECIFICATION

| | |
|---------------------------|-----------------|
| Model | FLAT 150 X 50 |
| Powe (max) | 15-19 kw |
| Outlet temperature/smoke | 250°C |
| Efficiency | 75% |
| Consume | 3-4 kg/h |
| Fireplace material | Ceramic / Steel |
| Fan air supply | 100 x 230 mm |
| Hot air outlet | 4 x ø100 mm |
| Weight | 420 kg |
| Air temperature at outlet | 120°C |
| Fuel | Wood/Briquette |
| Pipe diameter | ø 250 mm |
| Glass | Ceramic |
| Warranty | 5 years |

OVERALL DIMENSION

| | |
|--------|---------|
| Height | 1500 mm |
| Depth | 600 mm |
| Width | 1753 mm |

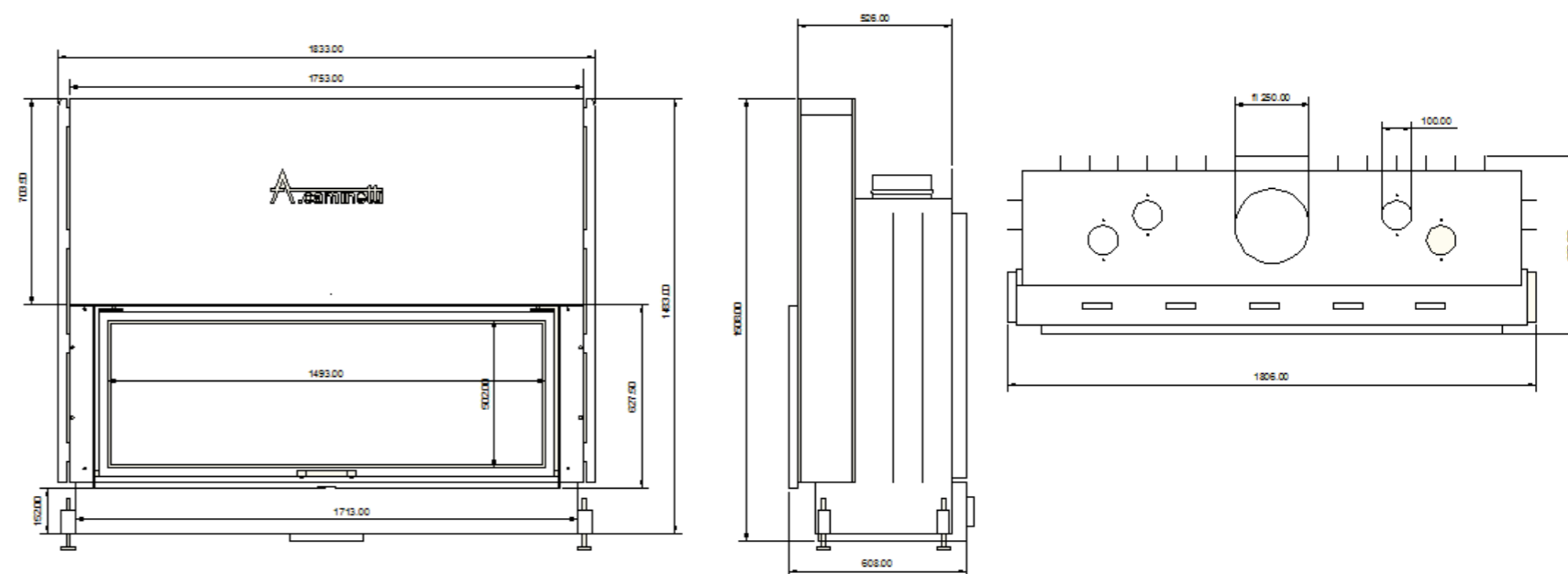

FLAT 180 X 50

A.camineti

SERIA Flat

TECHNICAL SPECIFICATION

| | |
|---------------------------|-----------------|
| Model | FLAT 180x 50 |
| Powe (max) | 20 kw |
| Outlet temperature/smoke | 270°C |
| Efficiency | 75% |
| Consume | 4-5 kg/h |
| Fireplace material | Ceramic / Steel |
| Fan air supply | 100 x 230 mm |
| Hot air outlet | 4 x ø100 mm |
| Weight | 470 kg |
| Air temperature at outlet | 120°C |
| Fuel | Wood/Briquette |
| Pipe diameter | ø 250 mm |
| Glass | Ceramic |
| Warranty | 5 years |

OVERALL DIMENSION

| | |
|--------|---------|
| Height | 1500 mm |
| Depth | 600 mm |
| Width | 2053 mm |

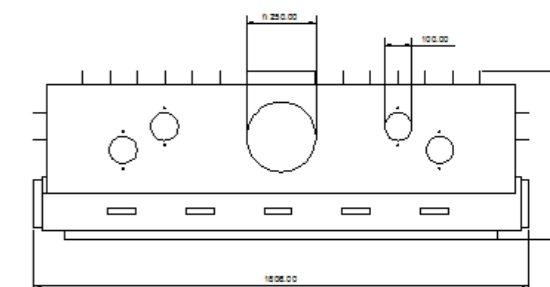
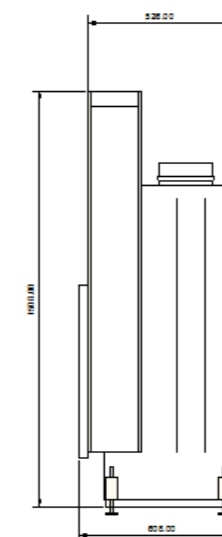
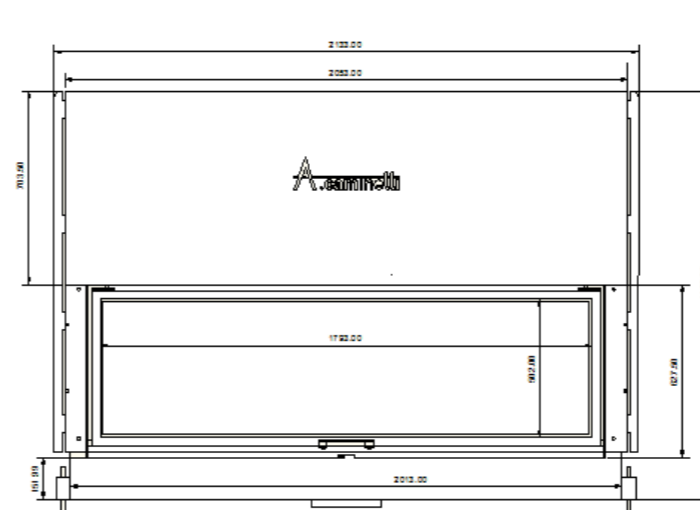

FLAT W 75 X 60

A.caminetti

SERIA Flat

TECHNICAL SPECIFICATION

| | |
|---------------------------|-----------------|
| Model | FLAT w 75 X 60 |
| Powe (max) | 10 kw |
| Outlet temperature/smoke | 230°C |
| Efficiency | 80% |
| Consume | 2-3 kg/h |
| Fireplace material | Ceramic / Steel |
| Fan air supply | - |
| Hot air outlet | 4 x ø100 mm |
| Weight | 324 kg |
| Air temperature at outlet | 120°C |
| Fuel | Wood/Briquette |
| Pipe diameter | ø 200 mm |
| Glass | Ceramic |
| Warranty | 5 years |

OVERALL DIMENSION

| | |
|--------|---------|
| Height | 1550 mm |
| Depth | 660 mm |
| Width | 1083 mm |

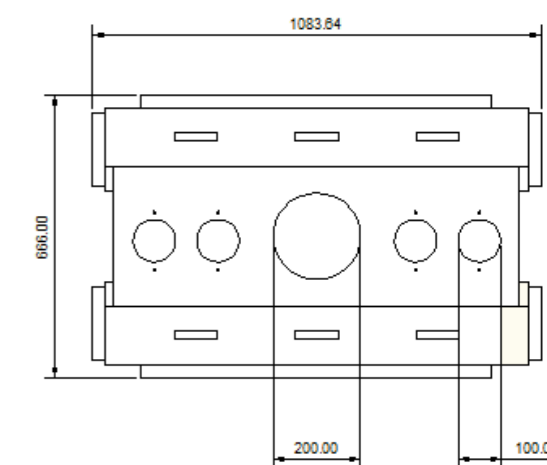
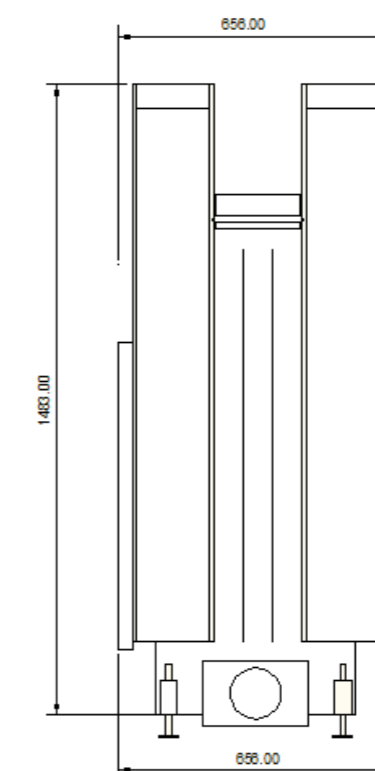
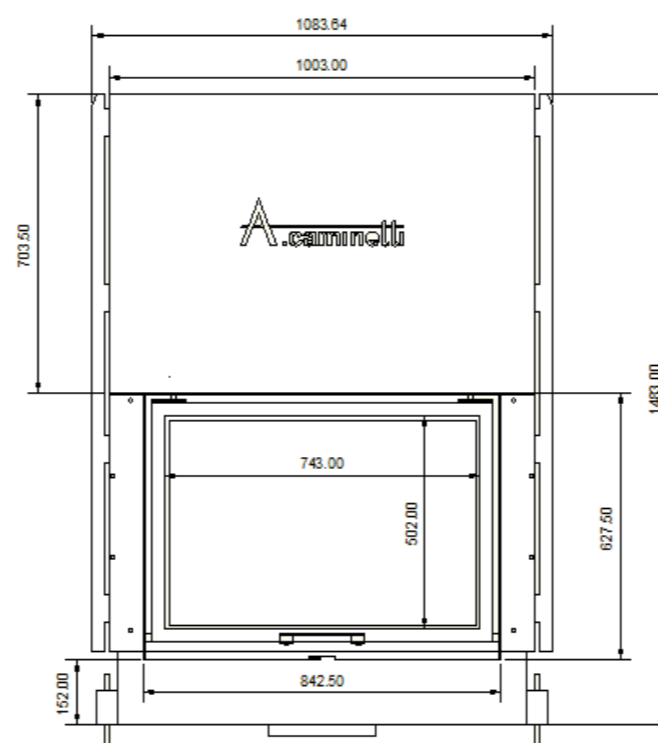
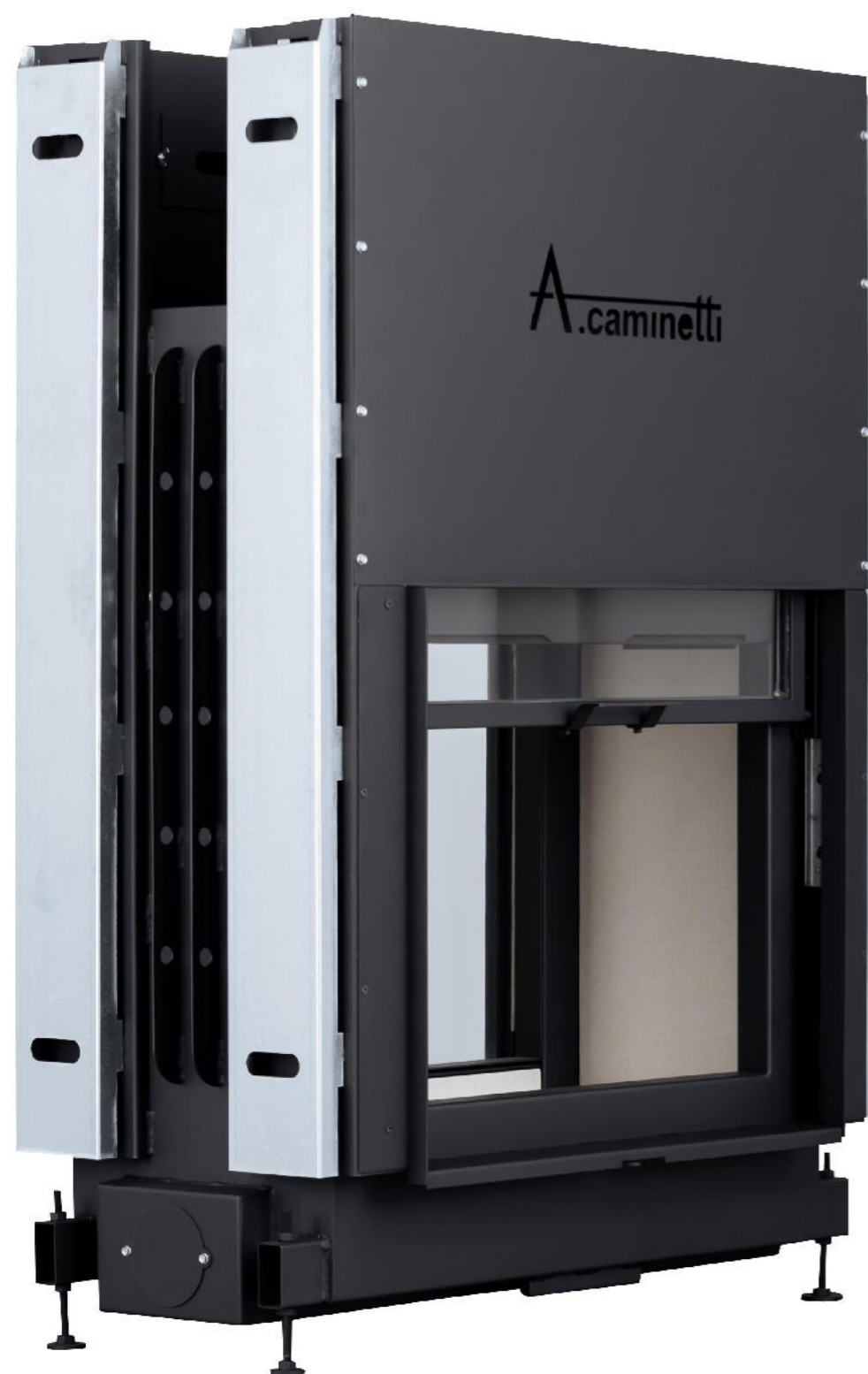

FLAT w 90 X 60

A.caminetti

SERIA Flat

TECHNICAL SPECIFICATION

| | |
|---------------------------|-----------------|
| Model | FLAT W 90 X 60 |
| Powe (max) | 13 kw |
| Outlet temperature/smoke | 230°C |
| Efficiency | 80% |
| Consume | 2-3 kg/h |
| Fireplace material | Ceramic / Steel |
| Fan air supply | - |
| Hot air outlet | 4 x ø100 mm |
| Weight | 354 kg |
| Air temperature at outlet | 120°C |
| Fuel | Wood/Briquette |
| Pipe diameter | ø 200 mm |
| Glass | Ceramic |
| Warranty | 5 years |

OVERALL DIMENSION

| | |
|--------|---------|
| Height | 1550 mm |
| Depth | 600 mm |
| Width | 1233 mm |

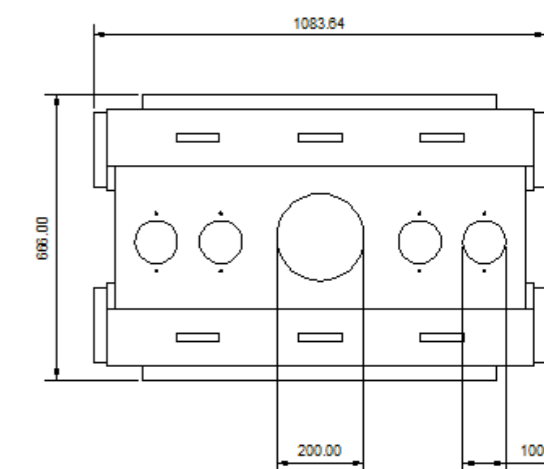
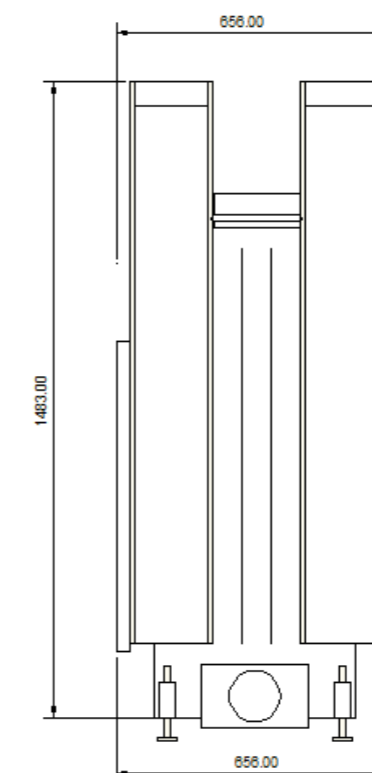
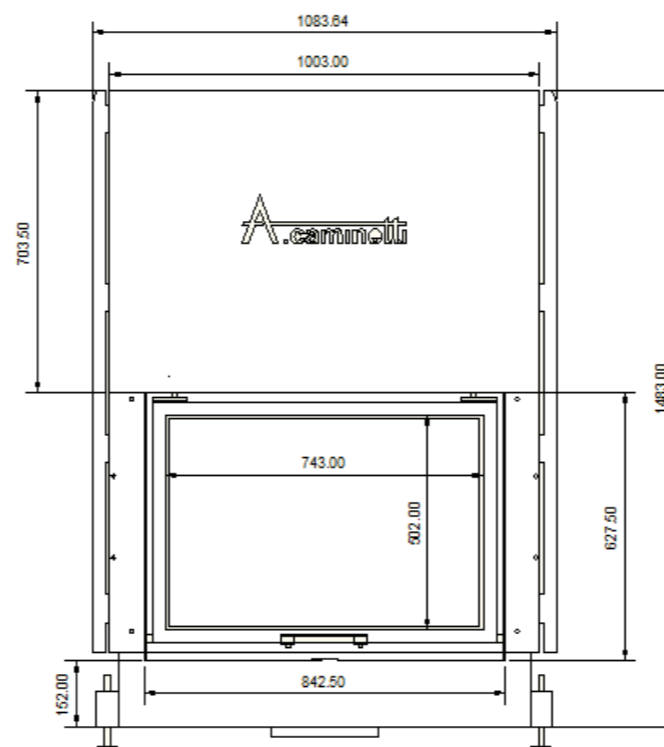

FLAT w 120 X 60

A.caminetti

SERIA Flat

TECHNICAL SPECIFICATION

| | |
|---------------------------|-----------------|
| Model | FLAT w 120 X 60 |
| Powe (max) | 15 kw |
| Outlet temperature/smoke | 240°C |
| Efficiency | 80% |
| Consume | 3 kg/h |
| Fireplace material | Ceramic / Steel |
| Fan air supply | - |
| Hot air outlet | 4 x ø100 mm |
| Weight | 400 kg |
| Air temperature at outlet | 120°C |
| Fuel | Wood/Briquette |
| Pipe diameter | ø 250 mm |
| Glass | Ceramic |
| Warranty | 5 years |

OVERALL DIMENSION

| | |
|--------|---------|
| Height | 1650 mm |
| Depth | 660 mm |
| Width | 1453 mm |

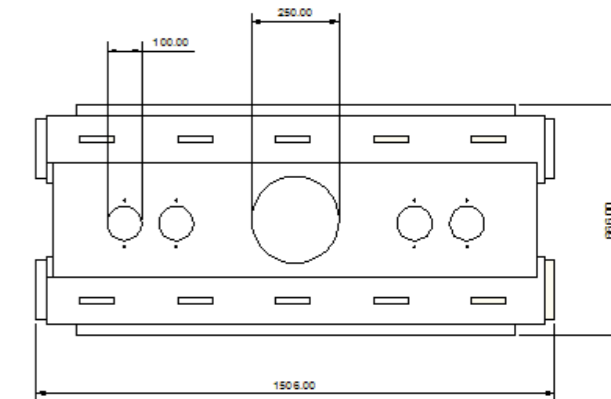
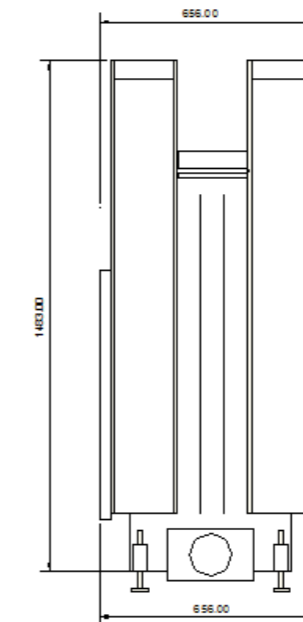
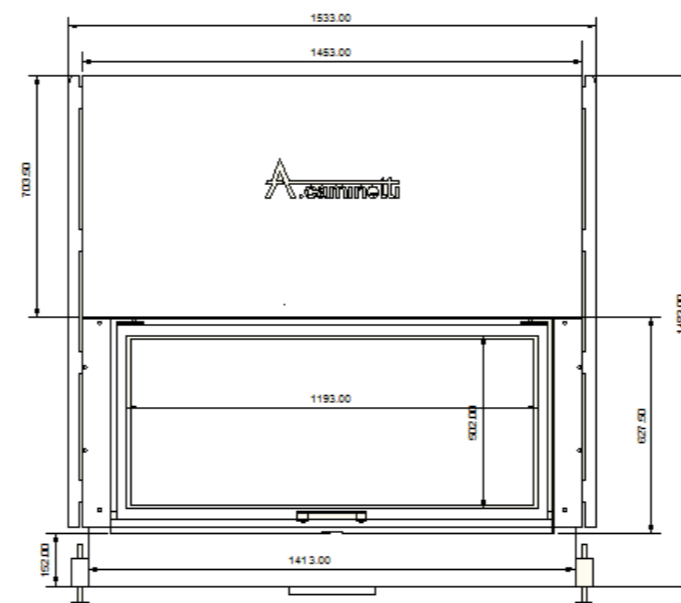

PRIZMA



A.caminetti

SERIA Prizma

TECHNICAL SPECIFICATION

| | |
|---------------------------|----------------|
| Model | PRIZMA |
| Power (max) | 13 kw |
| Outlet temperature/smoke | 290°C |
| Efficiency | 75% |
| Consume | 3-4 kg/h |
| Fireplace Material | Ceramic/Steel |
| Fan air supply | 100 x 230 mm |
| Hot air outlet | 4 x ø100 mm |
| Weight | 224 kg |
| Air temperature at outlet | 120°C |
| Fuel | Wood/Briquette |
| Pipe diameter | ø 250 mm |
| Glass | Ceramic |
| Warranty | 5 years |

OVERALL DIMENSION

| | |
|--------|---------|
| Height | 1550 mm |
| Depth | 550 mm |
| Width | 990 mm |

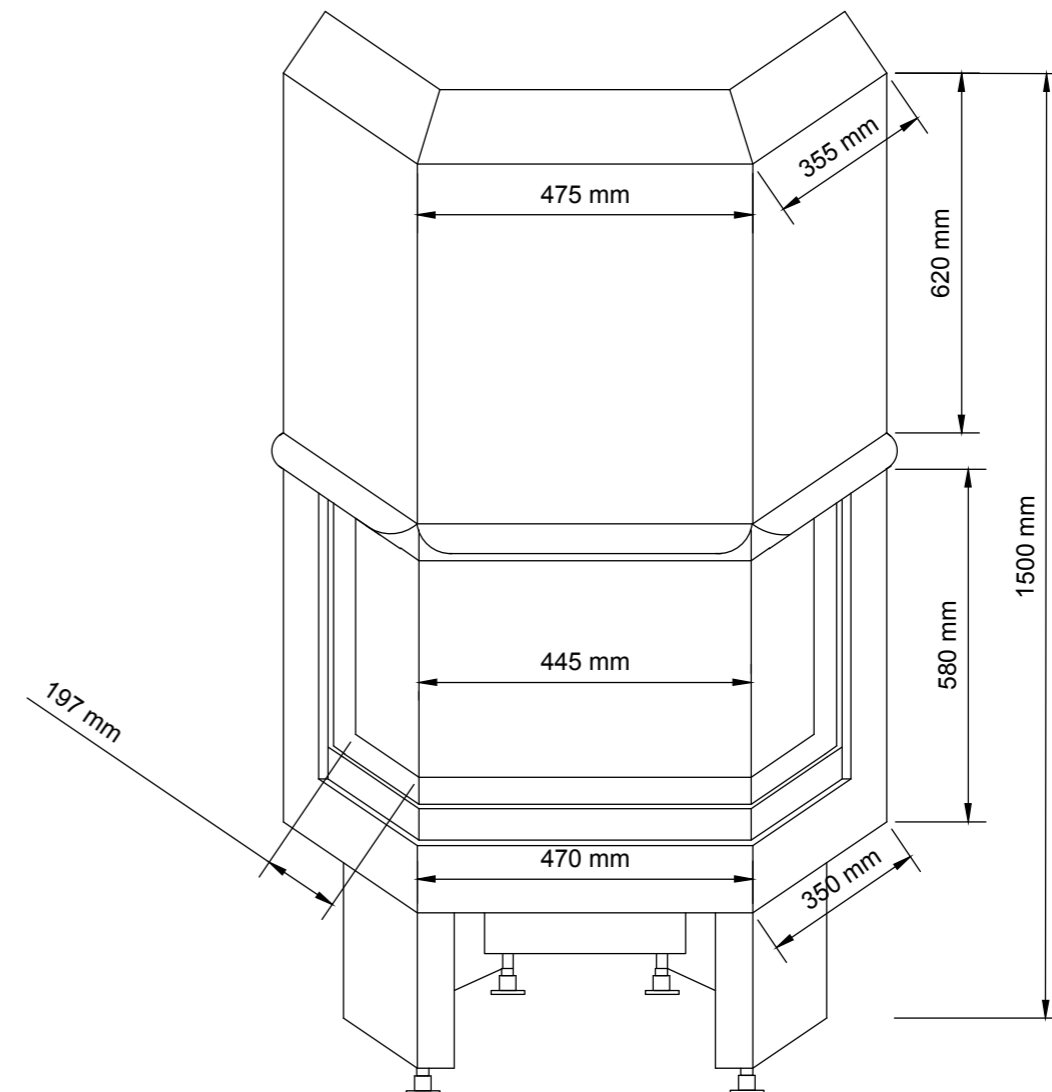

CRYSTAL 70 MAX

A.caminetti

SERIA Crystal

TECHNICAL SPECIFICATION

| | |
|---------------------------|-----------------|
| Model | CRYSTAL 70 MAX |
| Powe (max) | 8-10 kw |
| Outlet temperature/smoke | 200°C |
| Efficiency | 80% |
| Consume | 2-3 kg/h |
| Fireplace material | Ceramic / Steel |
| Fan air supply | 100 x 230 mm |
| Hot air outlet | 2 x ø100 mm |
| Weight | 244 kg |
| Air temperature at outlet | 120°C |
| Fuel | Wood/Briquette |
| Pipe diameter | ø 200 mm |
| Glass | Ceramic |
| Warranty | 5 years |

OVERALL DIMENSION

| | |
|--------|---------|
| Height | 1536 mm |
| Depth | 600 mm |
| Width | 730 mm |

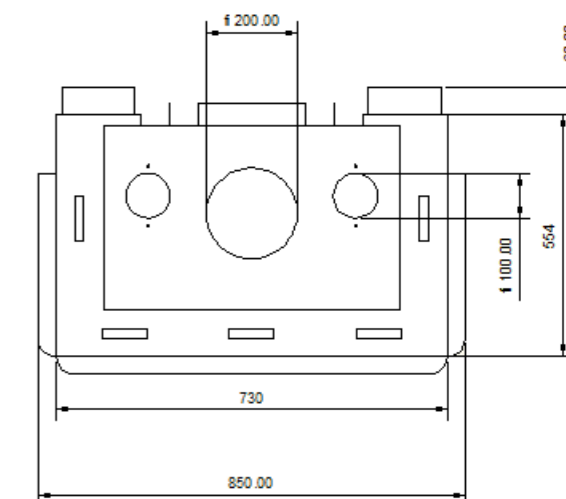
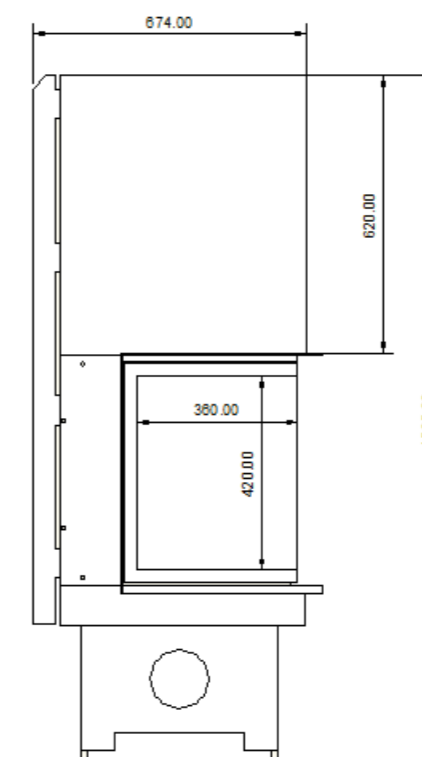
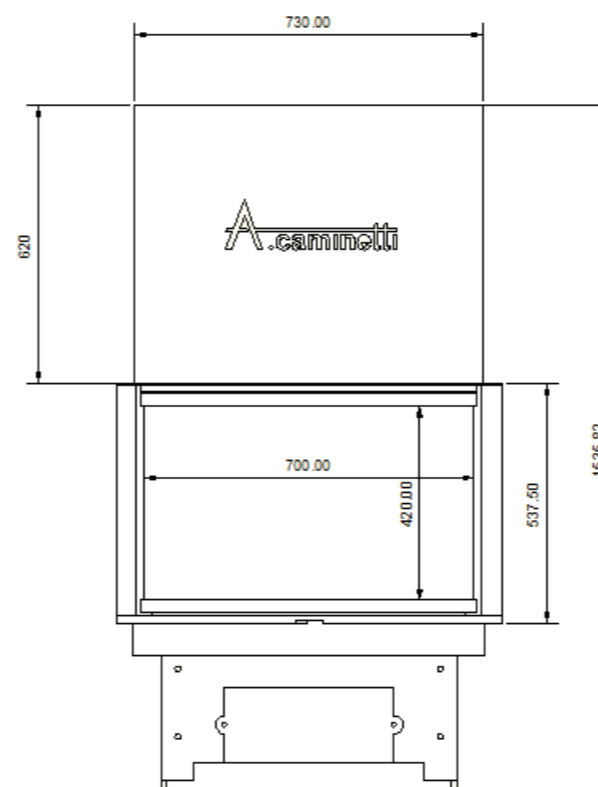

CRYSTAL 90 MAX

A.caminetti

SERIA Crystal

TECHNICAL SPECIFICATION

| | |
|---------------------------|--------------------------|
| Model | CRYSTAL 90 MAX |
| Power (max) | 24 kw |
| Outlet temperature/smoke | 218°C |
| Efficiency | 80% |
| Consume | 3-4 kg/h |
| Fireplace material | Ceramic/steel |
| Fan air supply | 100 x 230 mm |
| Hot air outlet | 2 x \varnothing 100 mm |
| Weight | 280 kg |
| Air temperature at outlet | 120°C |
| Fuel | Wood/Briquette |
| Pipe diameter | \varnothing 200 mm |
| Glass | Ceramic |
| Warranty | 5 years |

OVERALL DIMENSION

| | |
|--------|--------|
| Height | 1536mm |
| Depth | 613 mm |
| Width | 890 mm |

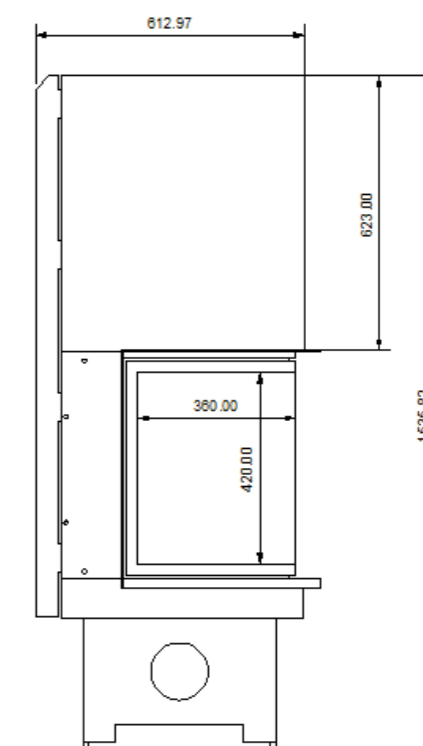
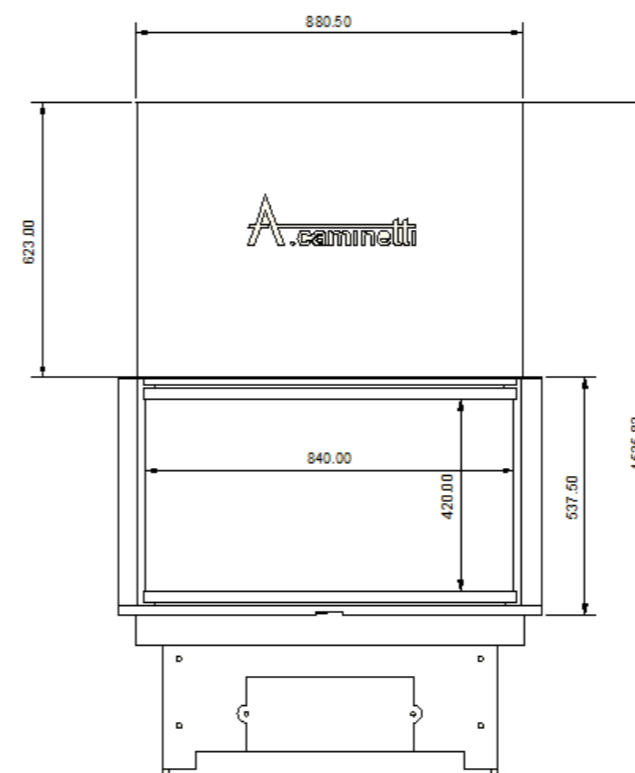
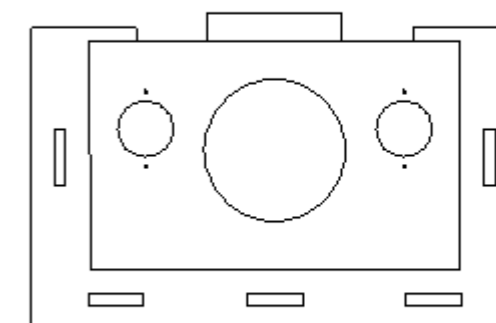

CRYSTAL 110 MAX

A.caminetti

SERIA Crystal

TECHNICAL SPECIFICATION

| | |
|---------------------------|-----------------------|
| Model | CRYSTAL 110 MAX Power |
| (max) | 16 kw |
| Outlet temperature/smoke | 220°C |
| Efficiency | 80% |
| Consume | 3-4 kg/h |
| Fireplace material | Ceramic /Steel |
| Fan air supply | 100 x 230 mm |
| Hot air outlet | 2 x ø100 mm |
| Weight | 327 kg |
| Air temperature at outlet | 120°C |
| Fuel | Wood/Briquette |
| Pipe diameter | ø 200 mm |
| Glass | Ceramic |
| Warranty | 5 year |

OVERALL DIMENSION

| | |
|--------|---------|
| Height | 1550 mm |
| Depth | 612 mm |
| Width | 1150 mm |

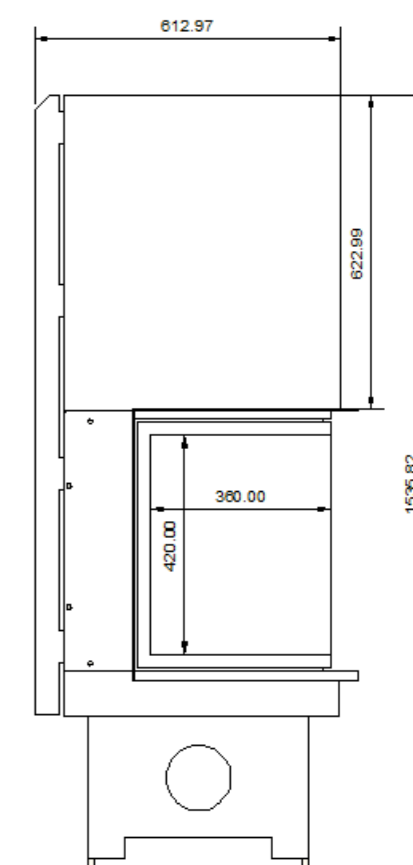
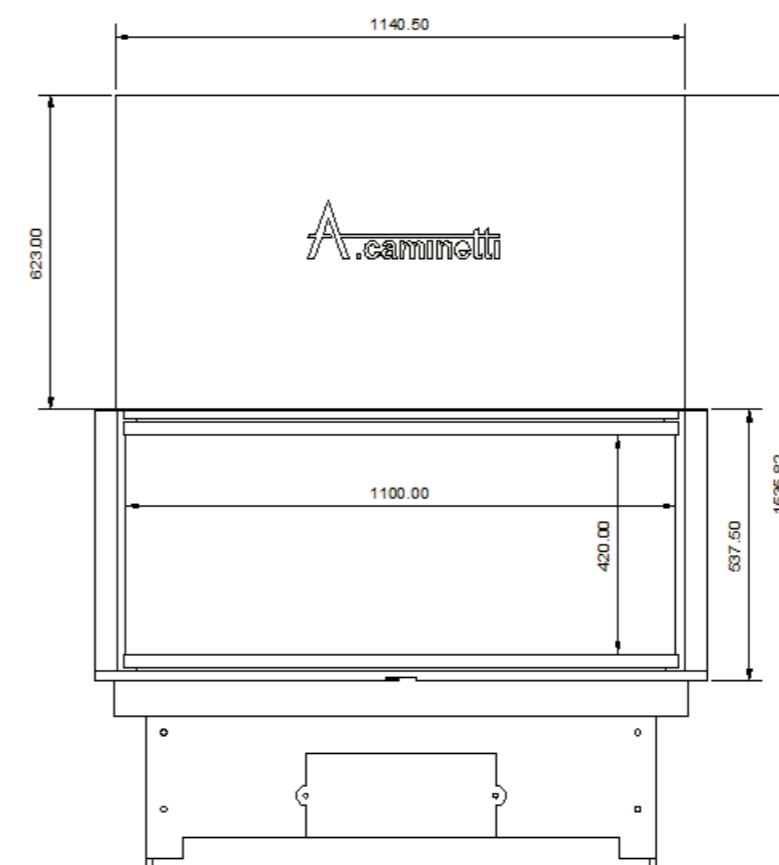
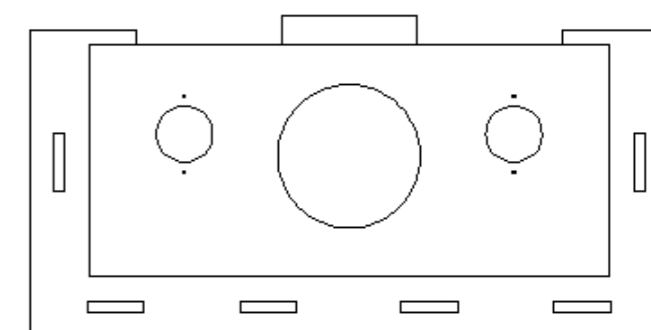



TECHNICAL SPECIFICATION

| | |
|---------------------------|------------------|
| Model | CRYSTAL 3D 50/60 |
| Powe (max) | 8-10 kw |
| Outlet temperature/smoke | 200°C |
| Efficiency | 80% |
| Consume | 2-3 kg/h |
| Fireplace material | Ceramic / Steel |
| Fan air supply | 100 x 230 mm |
| Hot air outlet | 2 x ø100 mm |
| Weight | 240 kg |
| Air temperature at outlet | 120°C |
| Fuel | Wood/Briquette |
| Pipe diameter | ø 200 mm |
| Glass | Ceramic |
| Warranty | 5 Year |

OVERALL DIMENSION

| | |
|--------|---------|
| Height | 1530 mm |
| Depth | 917 mm |
| Width | 535 mm |

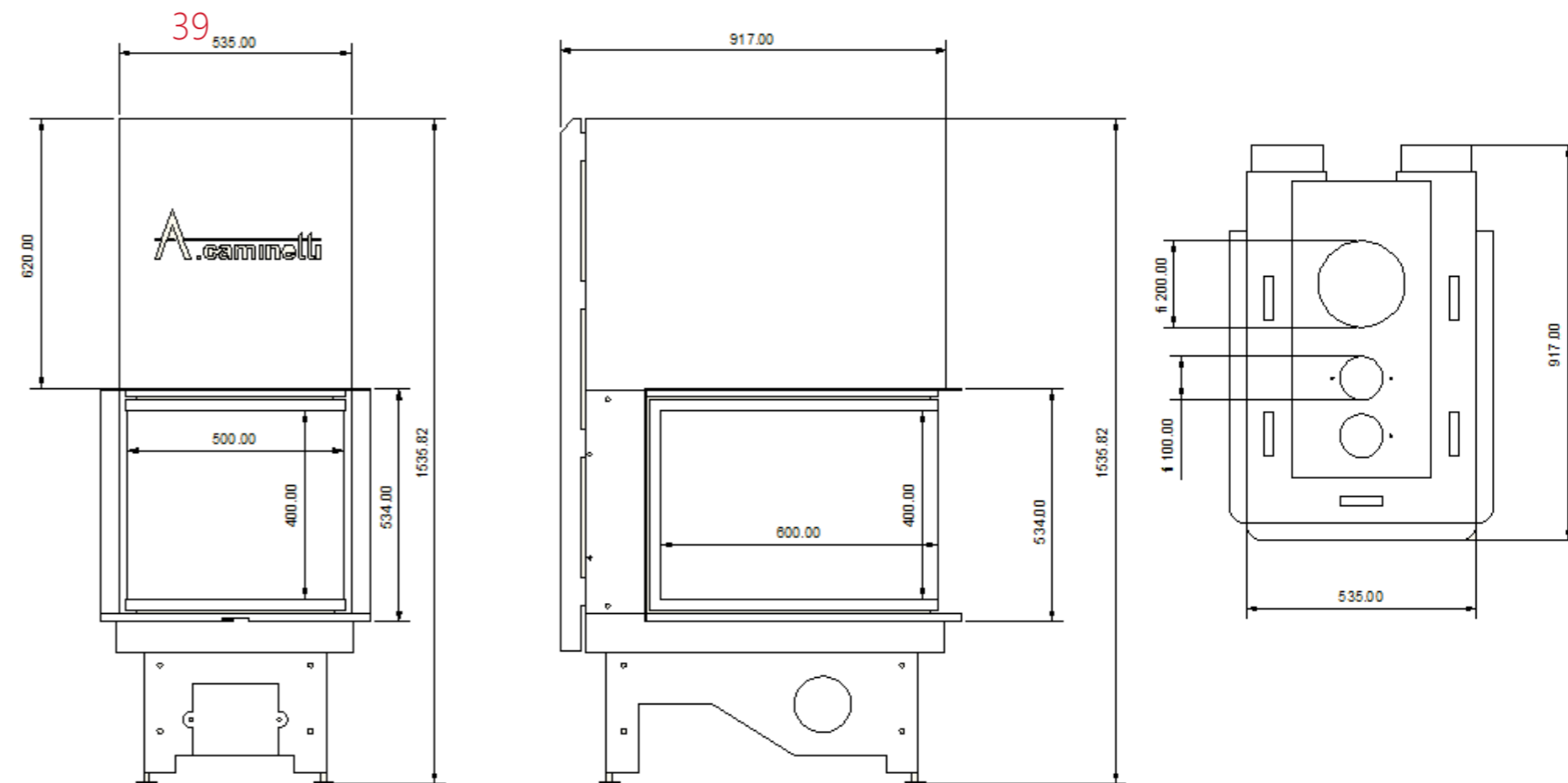

CRYSTAL 3D 50/70

A.caminetti

SERIA Flat

TECHNICAL SPECIFICATION

| | |
|---------------------------|------------------|
| Model | CRYSTAL 3D 50/70 |
| Powe (max) | 12 kw |
| Outlet temperature/smoke | 200°C |
| Efficiency | 80 % |
| Consume | 2-3 kg/h |
| Fireplace material | Ceramic / Steel |
| Fan air supply | 100 x 230 mm |
| Hot air outlet | 2 x ø100 mm |
| Weight | 285 kg |
| Air temperature at outlet | 120°C |
| Fuel | Wood/Briquette |
| Pipe diameter | ø 200 mm |
| Glass | Ceramic |
| Warranty | 5 Year |

OVERALL DIMENSION

| | |
|--------|----------|
| Height | 1530 mm |
| Depth | 1,017 mm |
| Width | 535 mm |

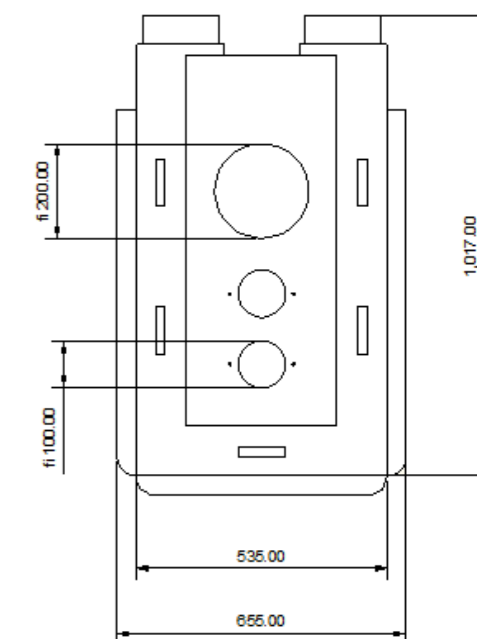
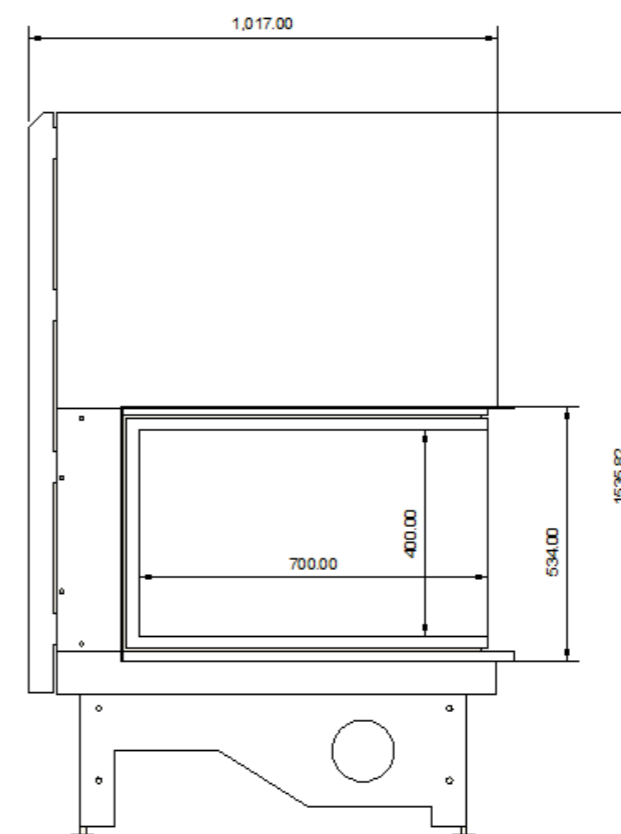
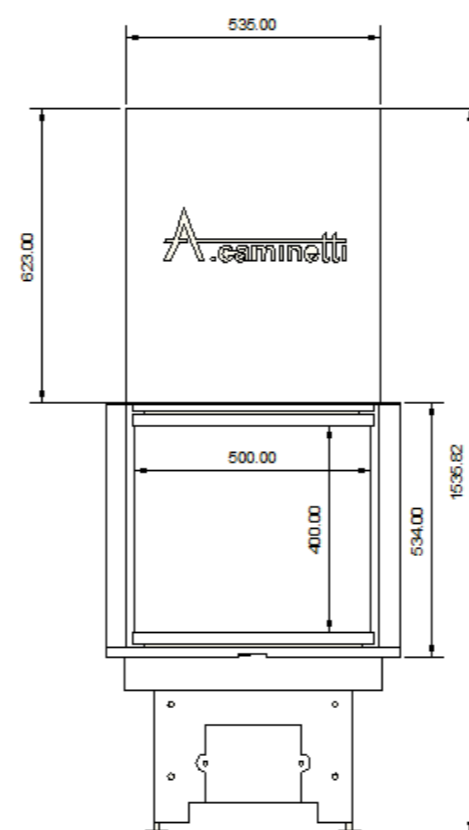

CRYSTAL 3D

A.caminetti

SERIA Crystal

TECHNICAL SPECIFICATION

| | |
|---------------------------|----------------|
| Model | CRYSTAL 3D |
| Power (max) | 12 kw |
| Outlet temperature/smoke | 230°C |
| Efficiency | 80% |
| Consume | 3-4 kg/h |
| Fireplace material | Ceramic/Steel |
| Fan air supply | 100 x 230 mm |
| Hot air outlet | 2 x Ø100 mm |
| Weight | 308 kg |
| Air temperature at outlet | 120°C |
| Fuel | Wood/Briquette |
| Pipe diameter | Ø 200 mm |
| Glass | Ceramic |
| Warranty | 5 Weight |

OVERALL DIMENSION

| | |
|--------|--------|
| Height | 1536mm |
| Depth | 993 mm |
| Width | 639 mm |

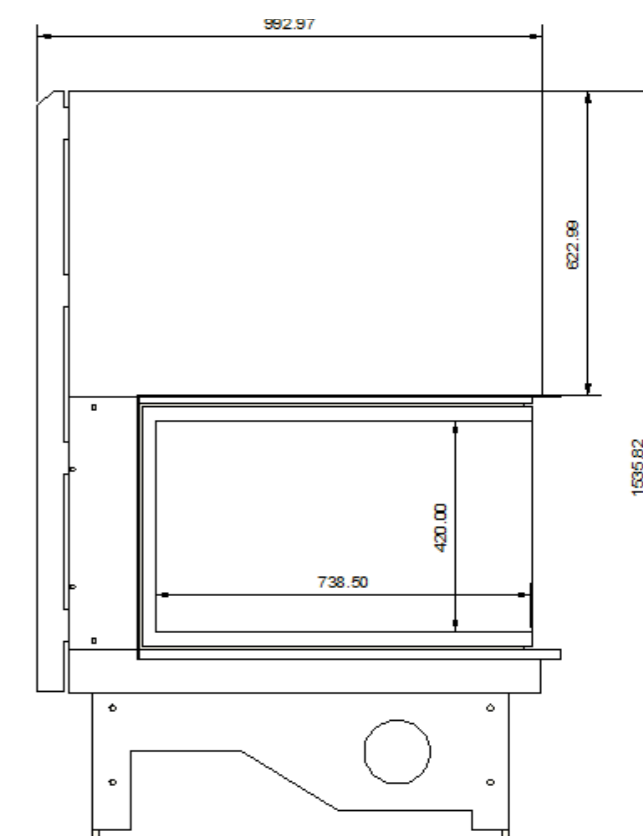
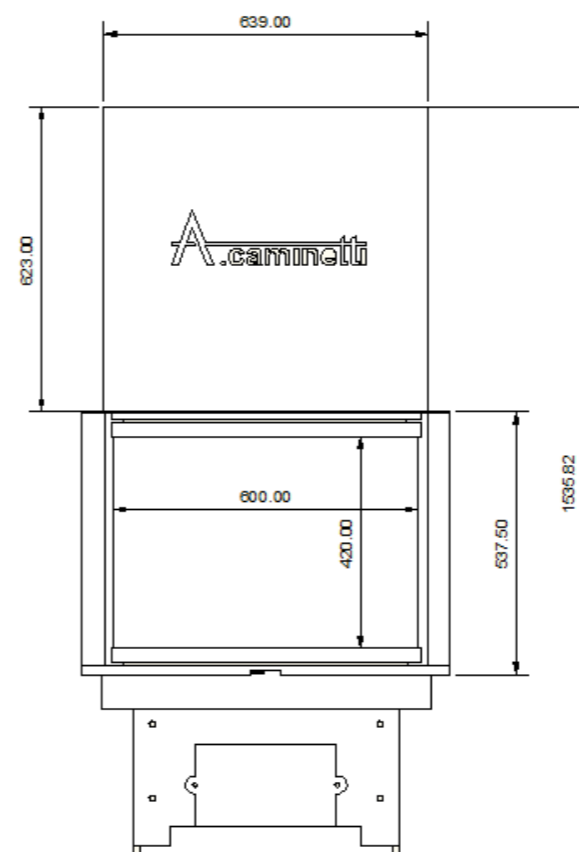
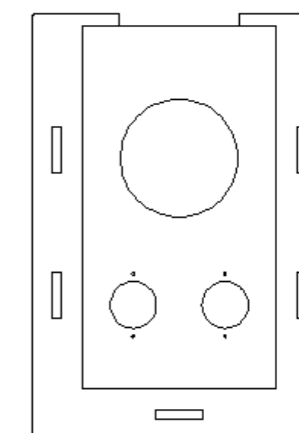

CRYSTAL 3D max

A.caminetti

SERIA Crystal

TECHNICAL SPECIFICATION

| | |
|---------------------------|----------------|
| Model | CRYSTAL 3D max |
| Power (max) | 16 kw |
| Outlet temperature/smoke | 220°C |
| Efficiency | 80% |
| Consume | 3-4 kg/h |
| Fireplace material | Ceramic/Steel |
| Fan air supply | 100 x 230 mm |
| Hot air outlet | 2 x ø100 mm |
| Weight | 350 kg |
| Air temperature at outlet | 120°C |
| Fuel | Wood/Briquette |
| Pipe diameter | ø 250 mm |
| Glass | Ceramic |
| Warranty | 5 Year |

OVERALL DIMENSION

| | |
|--------|---------|
| Height | 1540 mm |
| Depth | 639 mm |
| Width | 1173 mm |

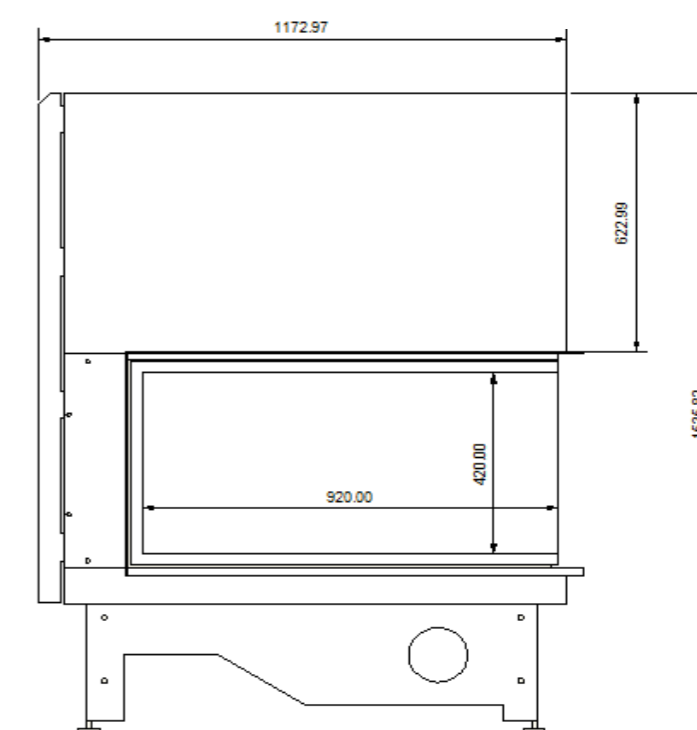
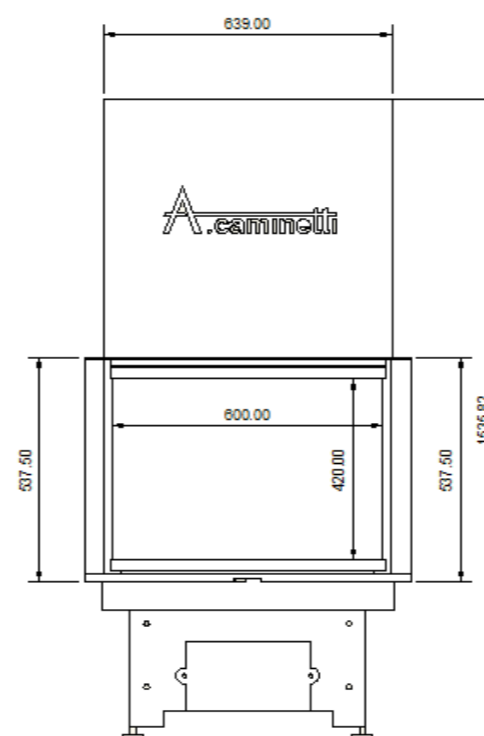
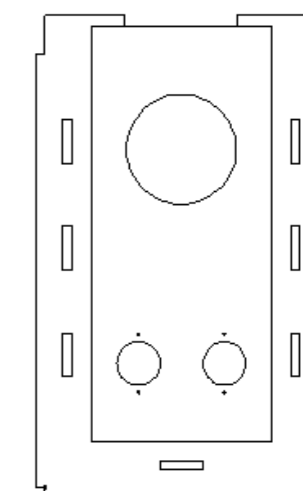

CRYSTAL 4D



A.caminetti

SERIA Crystal

TECHNICAL SPECIFICATION

| | |
|---------------------------|----------------|
| Model | CRYSTAL 4D |
| Power (max) | 20 kw |
| Outlet temperature/smoke | 290°C |
| Efficiency | 75% |
| Consume | 3-4 kg/h |
| Fireplace material | Ceramic/Steel |
| Fan air supply | — |
| Hot air outlet | — |
| Weight | 280 kg |
| Air temperature at outlet | 120°C |
| Fuel | Wood/Briquette |
| Pipe diameter | ø 250 mm |
| Glass | Ceramic |
| Warranty | 5 Year |

OVERALL DIMENSION

| | |
|--------|---------|
| Height | 1650 mm |
| Depth | 810 mm |
| Width | 1130 mm |

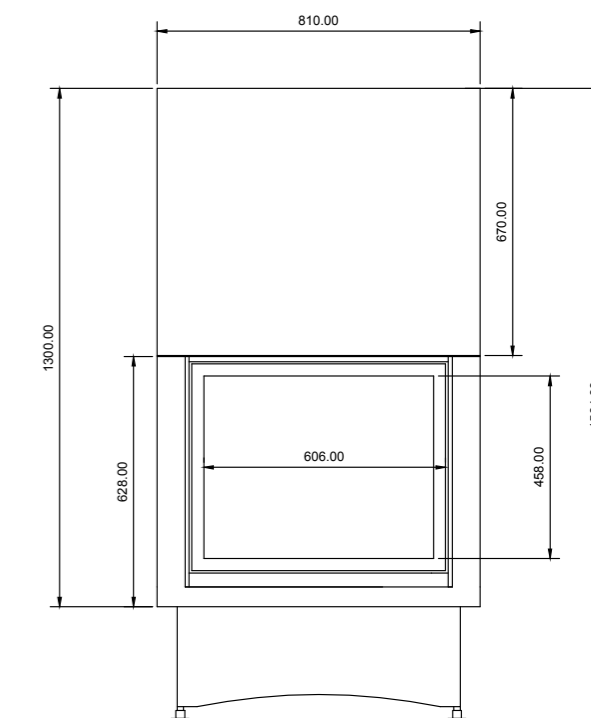
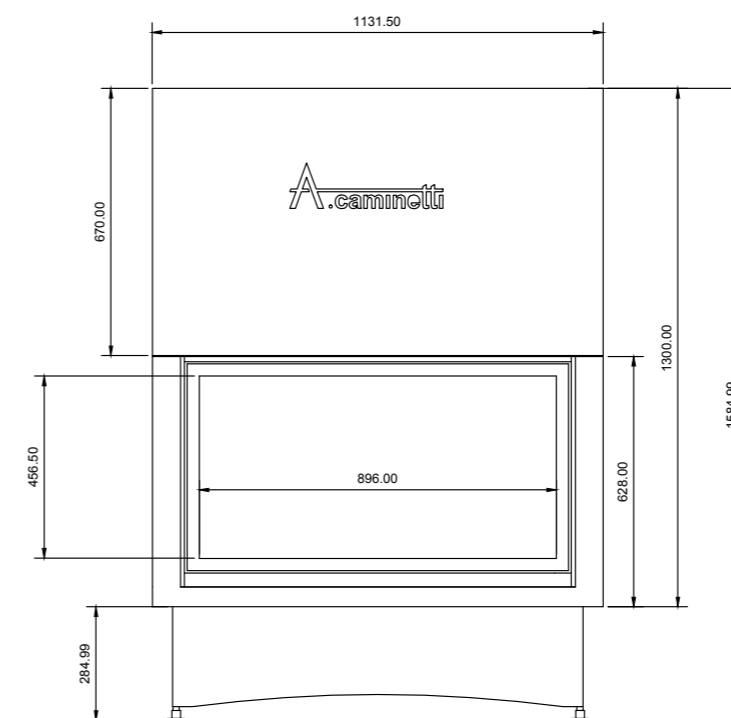

QUATTRO L80

A.caminetti

SERIA Quattro

TECHNICAL SPECIFICATION

OVERALL DIMENSION

| | |
|---------------------------|-----------------|
| Model | QUATTRO L80 |
| Powe (max) | 7-10 kw |
| Outlet temperature/smoke | 200°C |
| Efficiency | 80% |
| Consume | 2-3 kg/h |
| Fireplace material | Ceramic / Steel |
| Fan air supply | 100 x 230 mm |
| Hot air outlet | 2 x ø100 mm |
| Weight | 255 kg |
| Air temperature at outlet | 120°C |
| Fuel | Wood/Briquette |
| Pipe diameter | ø 200 mm |
| Glass | Ceramic |
| Weight | 5 Year |

| | |
|--------|---------|
| Height | 1550 mm |
| Depth | 600 mm |
| Width | 875 mm |

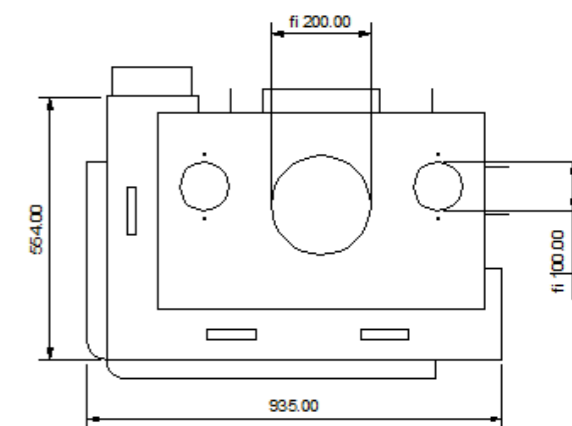
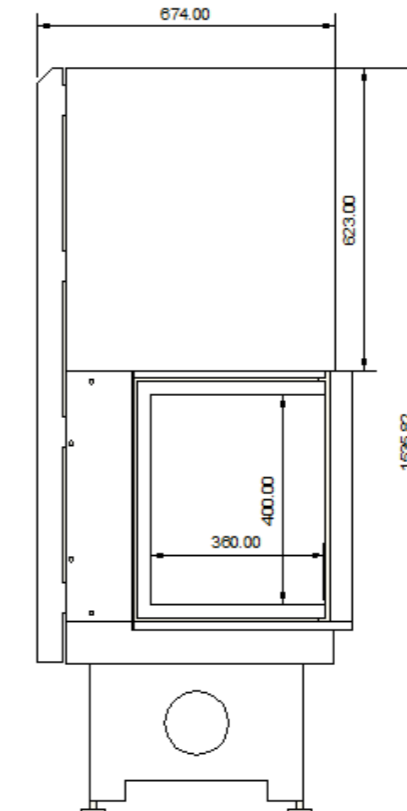
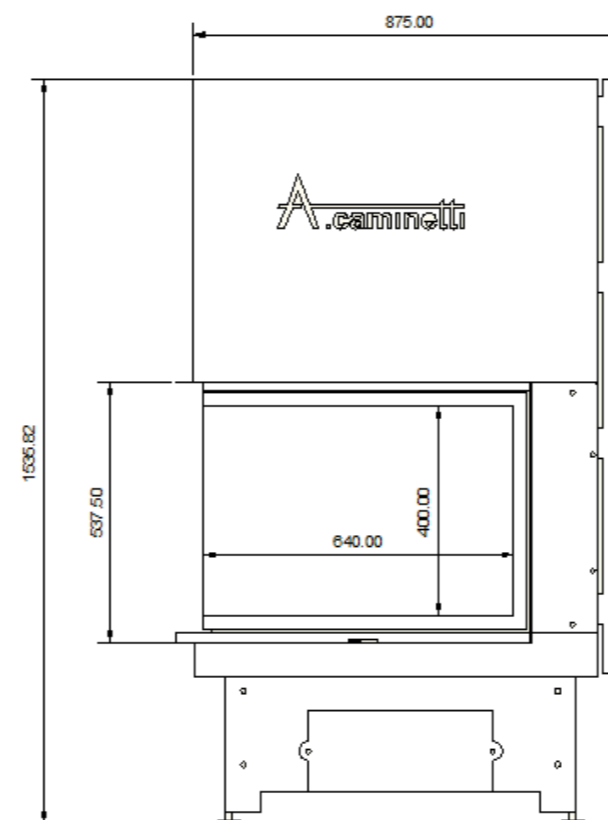

QUATTRO R80



A.caminetti

TECHNICAL SPECIFICATION

| | |
|---------------------------|-----------------|
| Model | QUATTRO R80 |
| Powe (max) | 7-10 kw |
| Outlet temperature/smoke | 200°C |
| Efficiency | 80% |
| Consume | 2-3 kg/h |
| Fireplace material | Ceramic / Steel |
| Fan air supply | 100 x 230 mm |
| Hot air outlet | 2 x ø100 mm |
| Weight | 255 kg |
| Air temperature at outlet | 120°C |
| Fuel | Wood/Briquette |
| Pipe diameter | ø 200 mm |
| Glass | Ceramic |
| Warranty | 5 Year |

SERIA Quattro

OVERALL DIMENSION

| | |
|--------|---------|
| Height | 1550 mm |
| Depth | 600 mm |
| Width | 875 mm |

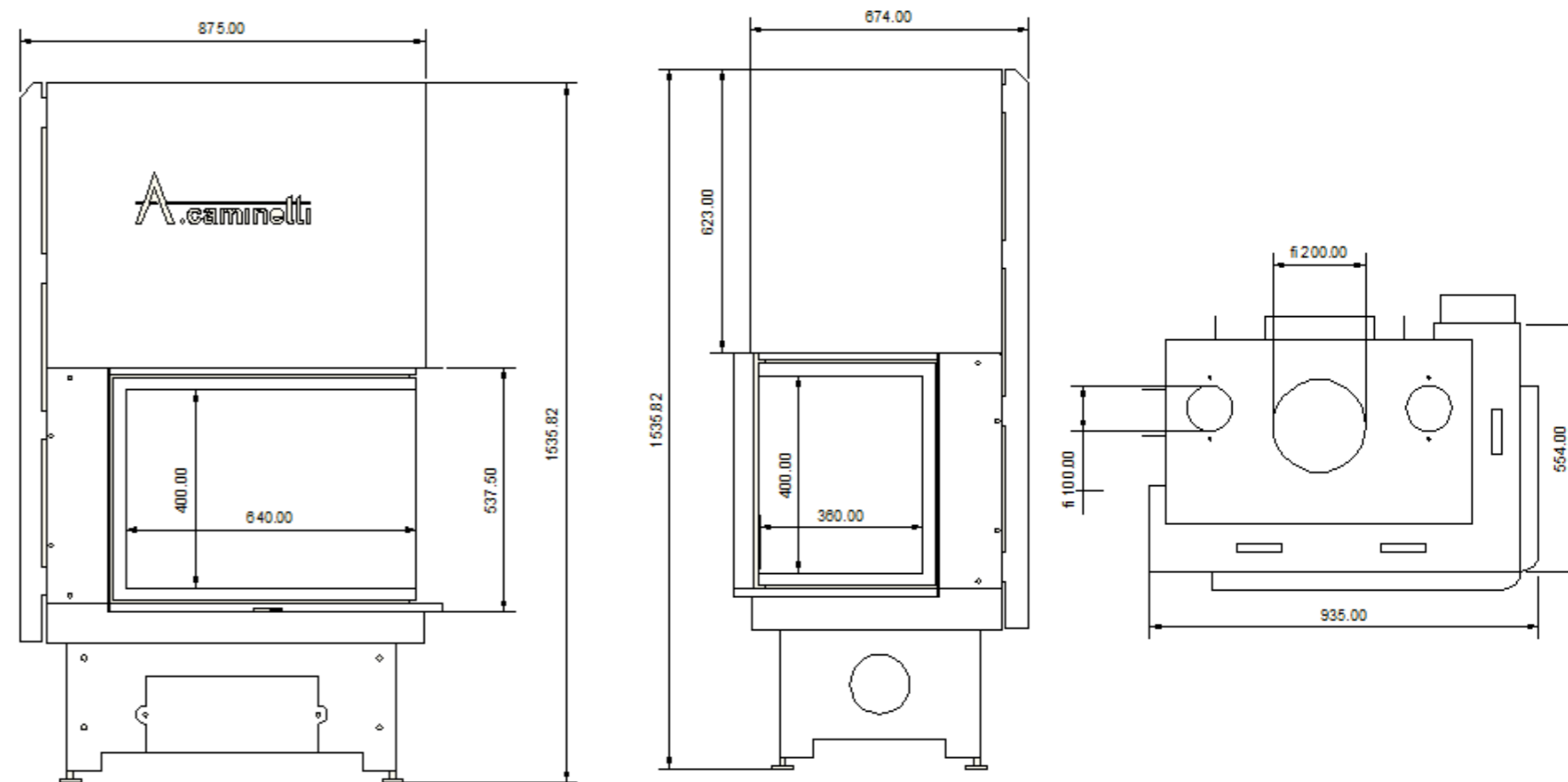

QUATTRO L90 MAX

A.caminetti

SERIA Quattro

TECHNICAL SPECIFICATION

| | |
|---------------------------|-----------------|
| Model | QUATTRO L90 MAX |
| Power (max) | 8-12 kw |
| Outlet temperature/smoke | 200°C |
| Efficiency | 80% |
| Consume | 2-3 kg/h |
| Fireplace Material | Ceramic/Steel |
| Fan air supply | 100 x 230 mm |
| Hot air outlet | 2 x ø100 mm |
| Weight | 285 kg |
| Air temperature at outlet | 120° |
| Fuel | Wood/Briquette |
| Pipe diameter | ø 200 mm |
| Glass | Ceramic |
| Warranty | 5 Year |

OVERALL DIMENSION

| | |
|--------|--------|
| Height | 1536mm |
| Depth | 613 mm |
| Width | 993 mm |

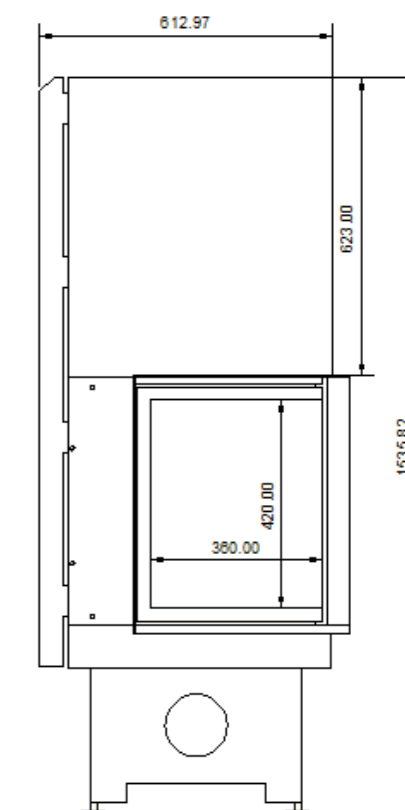
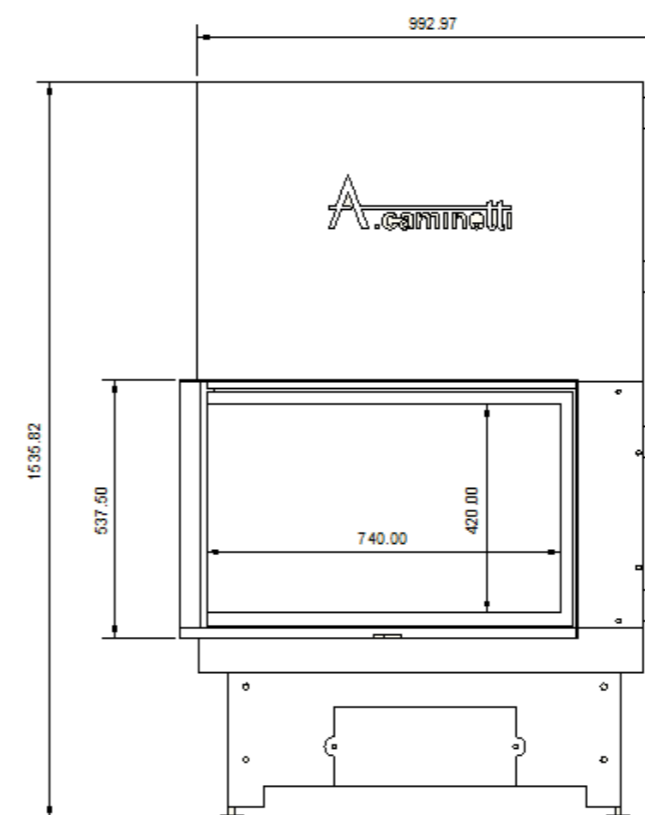
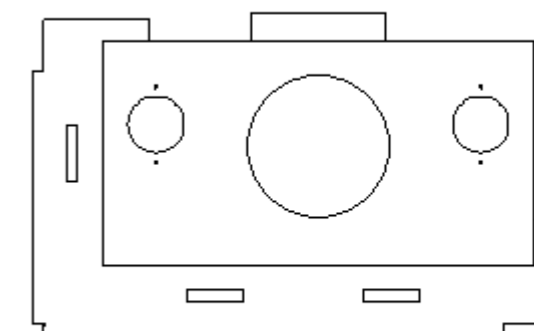

QUATTRO R90 MAX

A.camineti

SERIA Quattro

TECHNICAL SPECIFICATION

| | |
|---------------------------|-----------------|
| Model | QUATTRO R90 MAX |
| Power (max) | 8-12 kw |
| Outlet temperature/smoke | 200°C |
| Efficiency | 80% |
| Consume | 2-3 kg/h |
| Fireplace material | Ceramic/Steel |
| Fan air supply | 100 x 230 mm |
| Hot air outlet | 2 x ø100 mm |
| Weight | 285 kg |
| Air temperature at outlet | 120°C |
| Fuel | Wood/Briquette |
| Pipe diameter | ø 200 mm |
| Glass | Ceramic |
| Warranty | 5 Year |

OVERALL DIMENSION

| | |
|--------|--------|
| Height | 1536mm |
| Depth | 613 mm |
| Width | 993 mm |

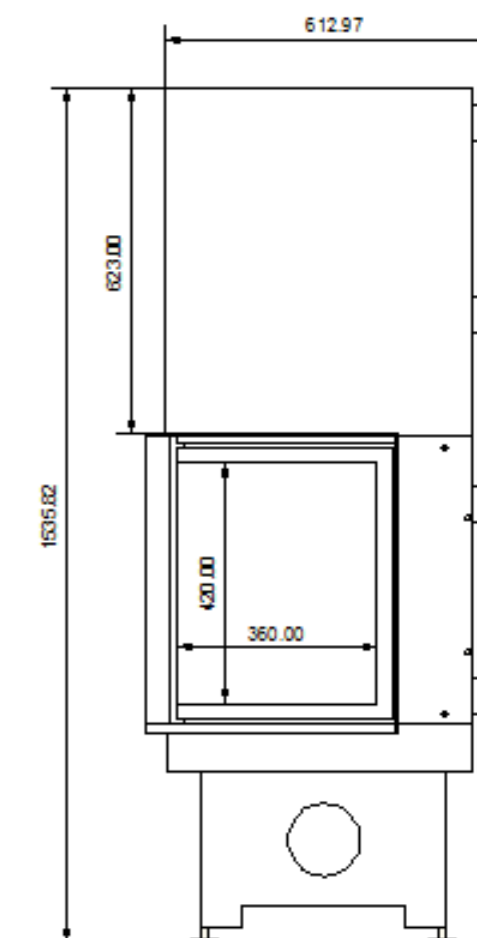
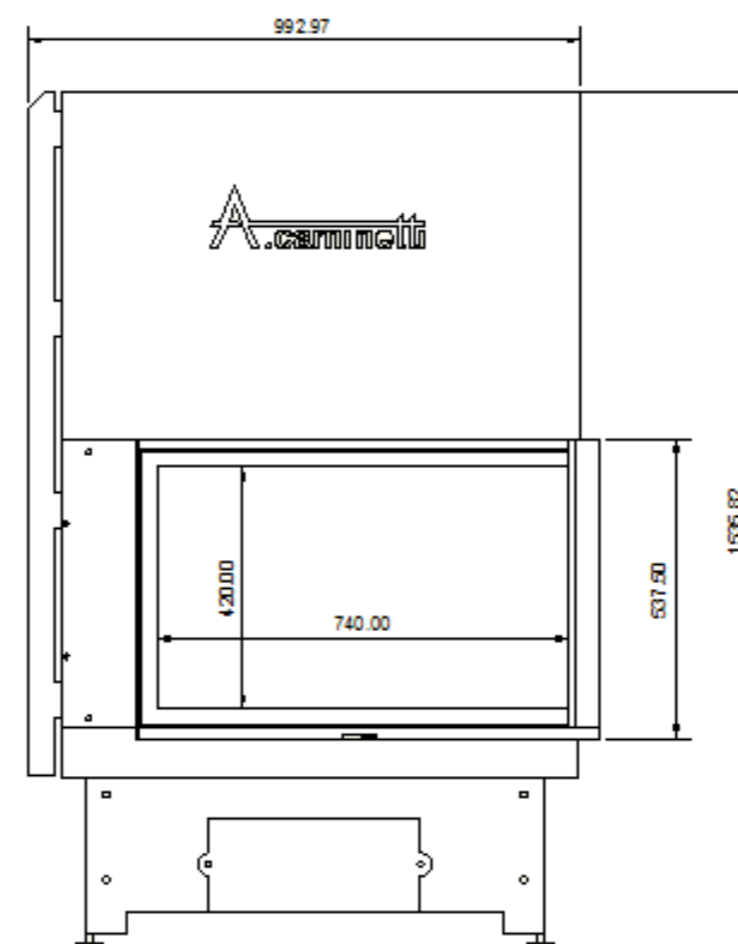
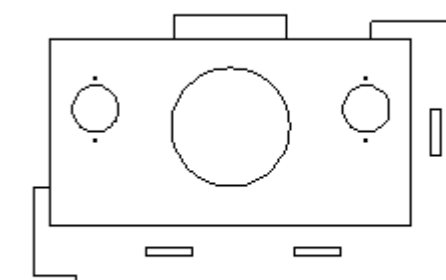

QUATTRO R100

A.caminetti

SERIA Quattro

TECHNICAL SPECIFICATION

| | |
|---------------------------|----------------|
| Model | QUATTRO R90 |
| Power (max) | 10-18 kw |
| Outlet temperature/smoke | 220°C |
| Efficiency | 80 % |
| Consume | 3-4 kg/h |
| Fireplace material | Ceramic /Steel |
| Fan air supply | 100 x 230 mm |
| Hot air outlet | 2 x ø100 mm |
| Weight | 310 kg |
| Air temperature at outlet | 120°C |
| Fuel | Wood/Briquette |
| Pipe diameter | ø 250 mm |
| Glass | Ceramic |
| Warranty | 5 year |

OVERALL DIMENSION

| | |
|--------|---------|
| Height | 1540mm |
| Depth | 612 mm |
| Width | 1252 mm |

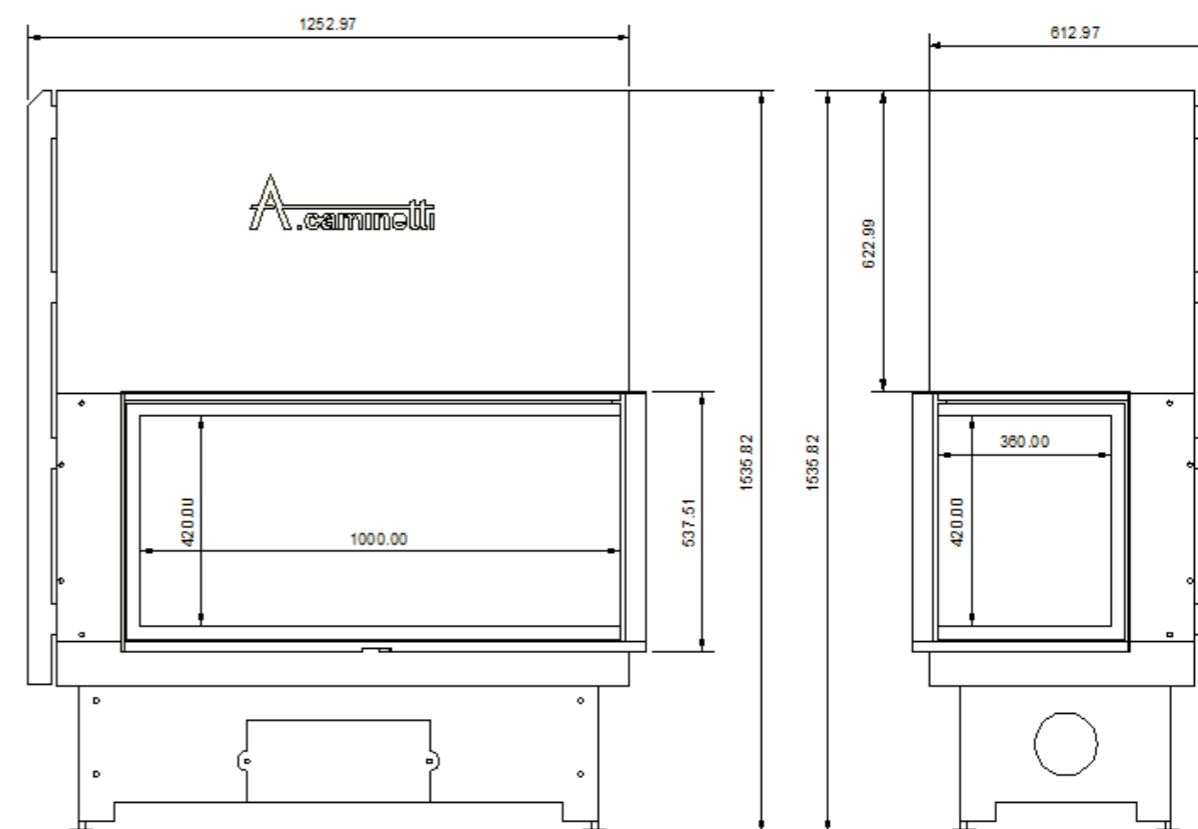
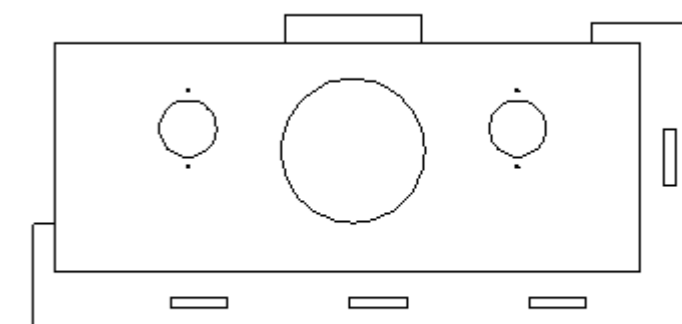

QUATTRO L100

A.camineti

SERIA Quattro

TECHNICAL SPECIFICATION

| | |
|---------------------------|----------------|
| Model | QUATTRO L100 |
| Power (max) | 10-18 kw |
| Outlet temperature/smoke | 220°C |
| Efficiency | 80 % |
| Consume | 3-4 kg/h |
| Fireplace material | Ceramic/Steel |
| Fan air supply | 100 x 230 mm |
| Hot air outlet | 2 x Ø100 mm |
| Weight | 310 kg |
| Air temperature at outlet | 120°C |
| Fuel | Wood/Briquette |
| Pipe diameter | Ø 250 mm |
| Glass | Ceramic |
| Warranty | 5 Year |

OVERALL DIMENSION

| | |
|--------|---------|
| Height | 1540mm |
| Depth | 612 mm |
| Width | 1252 mm |

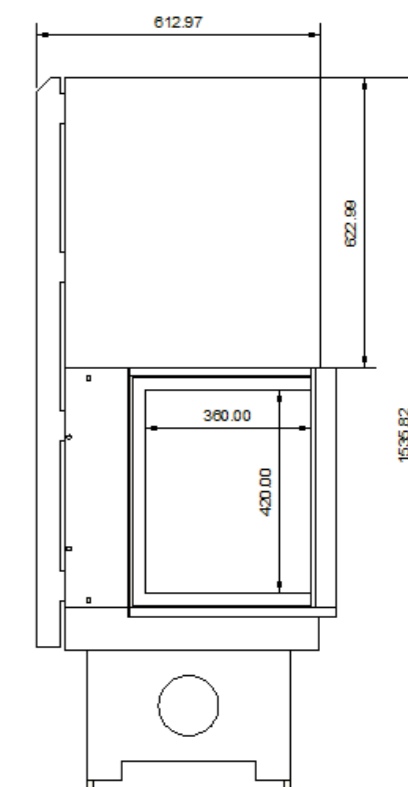
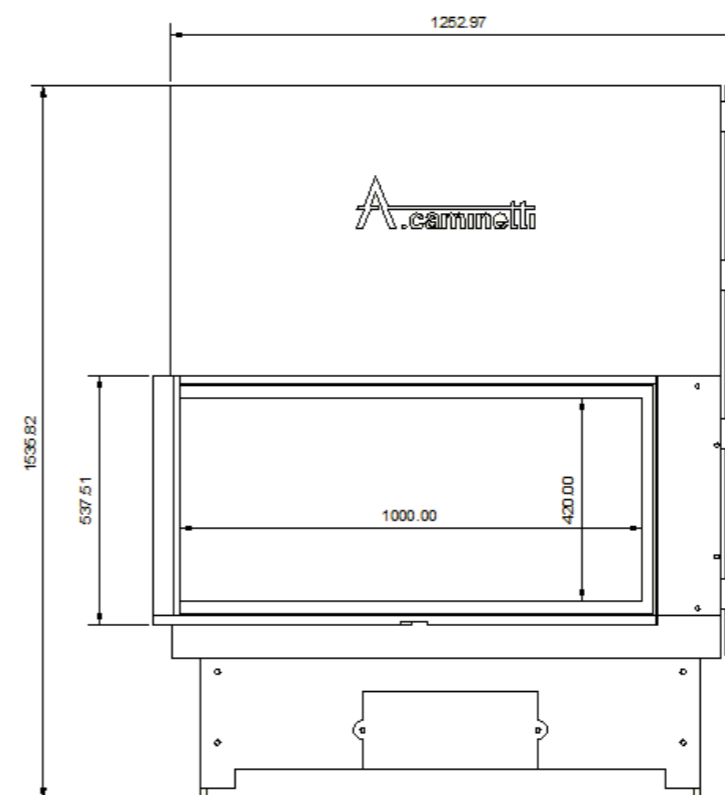
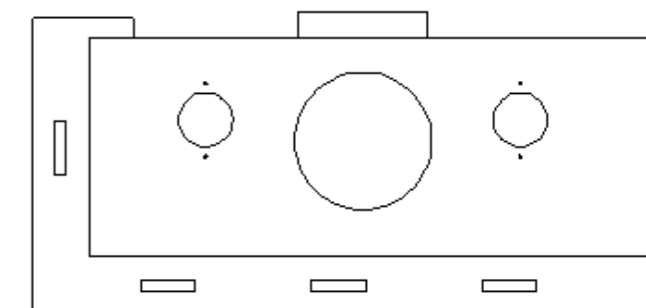

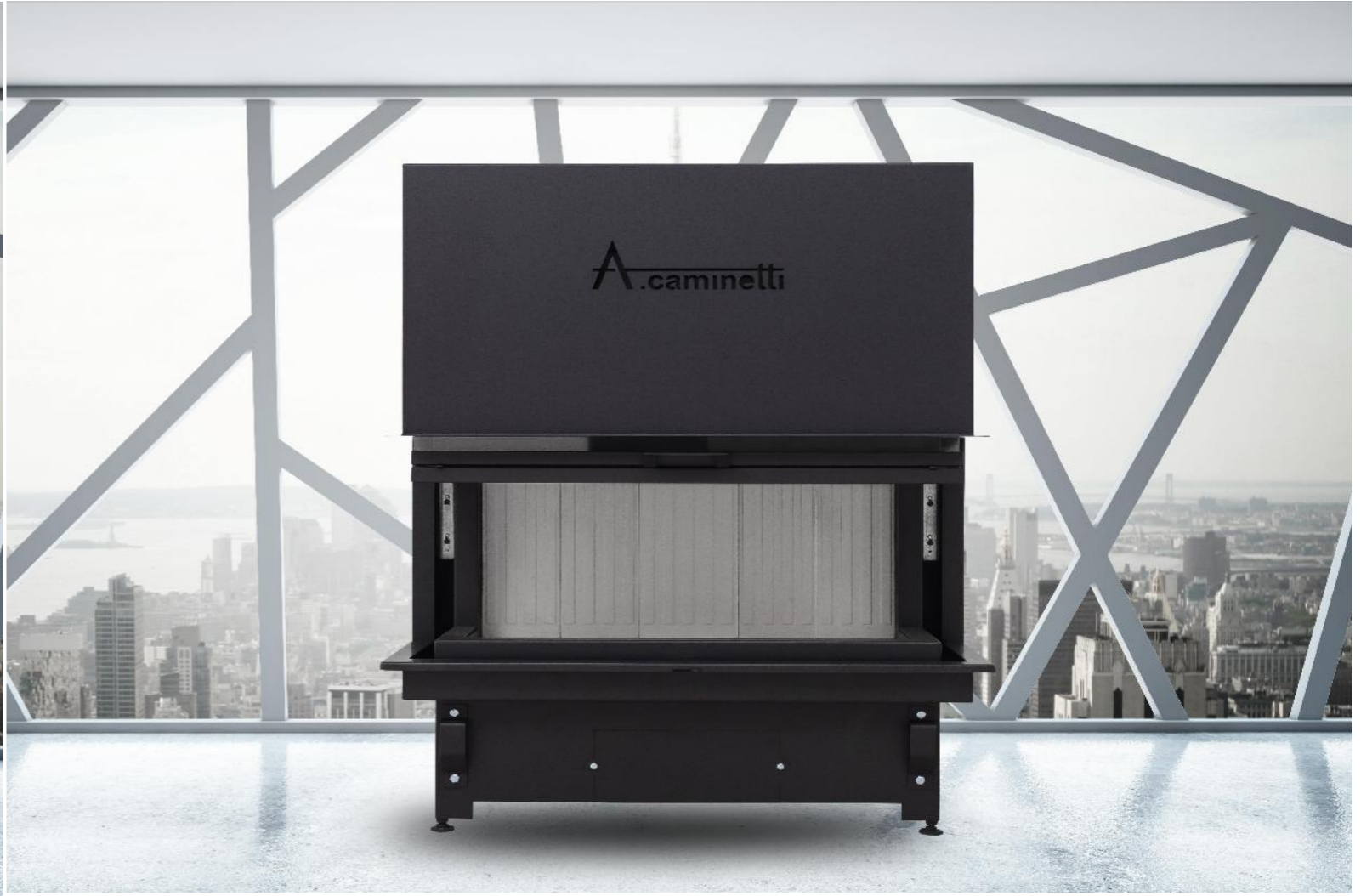
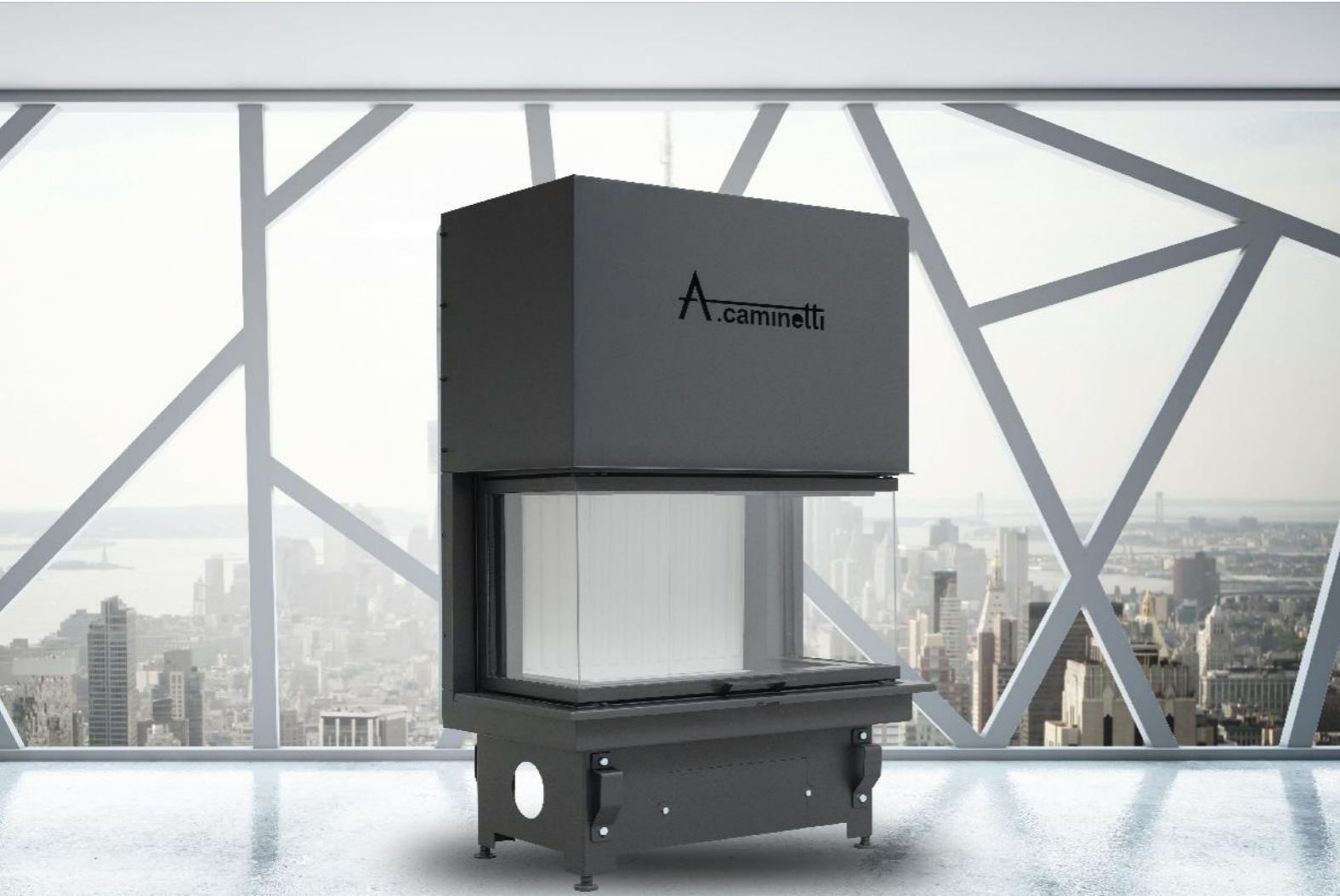

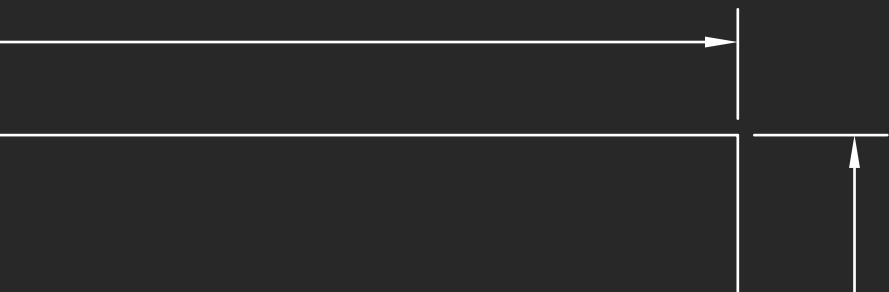

Factory address:
National Road Km2 Korce-Erseke

+355 695283522

+355 698070500

+355 698070900

info@acaminetti-factory.com

www.acaminetti-factory.com

